

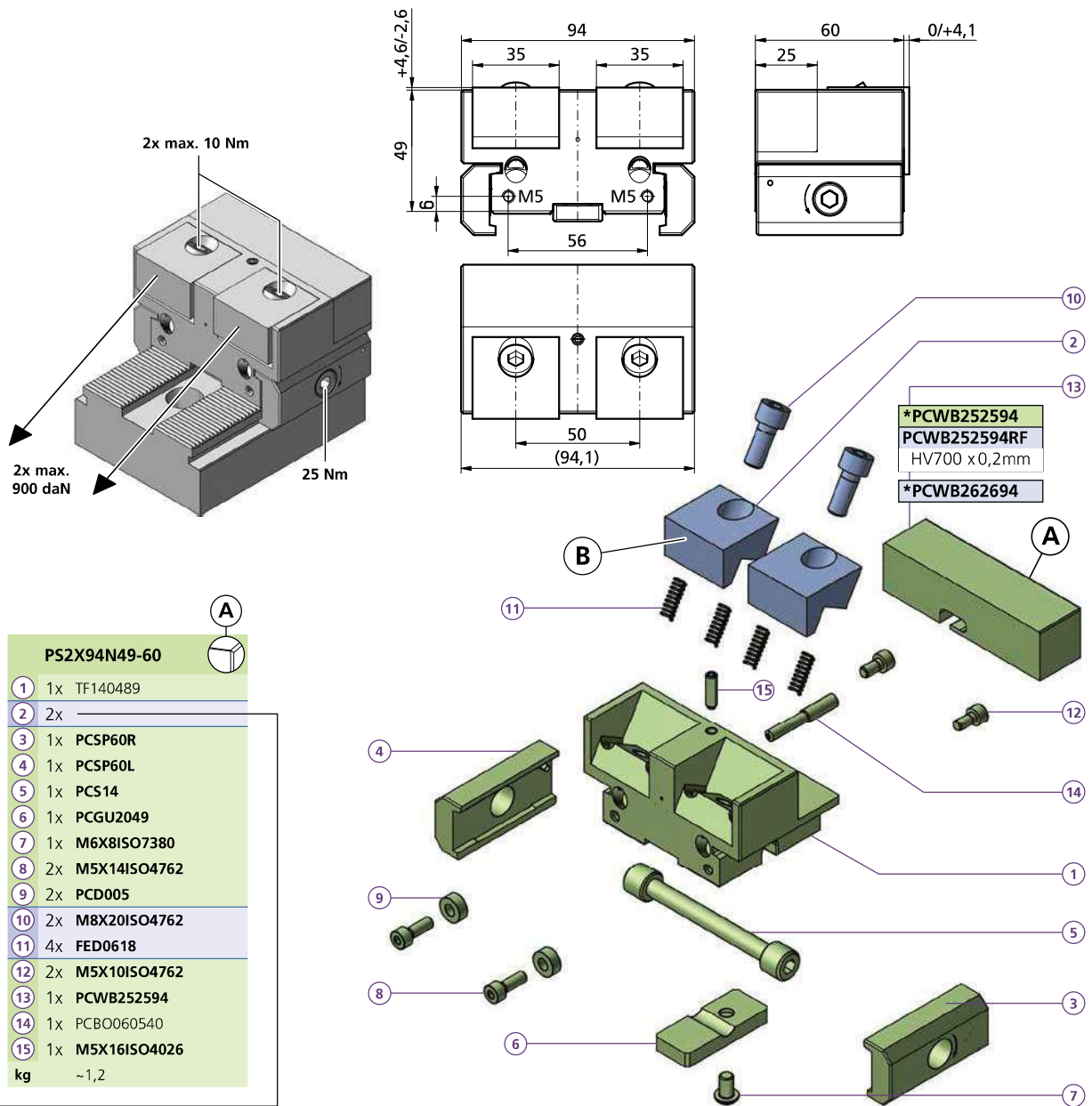

# PS2X94N49 -60

powerCLAMP



PS2X94N49-60	
1	1x TF140489
2	2x
3	1x PCSP60R
4	1x PCSP60L
5	1x PCS14
6	1x PCGU2049
7	1x M6X8ISO7380
8	2x M5X14ISO4762
9	2x PCD005
10	2x M8X20ISO4762
11	4x FED0618
12	2x M5X10ISO4762
13	1x PCWB252594
14	1x PCBO060540
15	1x M5X16ISO4026
kg	~1,2

Bestellbeispiel / Ordering example: 1x PS2X94N49-60 & 2x B58

	B58	B60	B61	B62	B62HM	B65	B66	B67	B68	B69	B77	B79F	B79R
C	35	35	35	35	35	35	35	35	35	35	35	35	35
H	20	20	20	20	20	20	20	20	20	25	20	20	20
L	26	19	19	19	19	19	19	24	26	22	22	25	25
D	9	9	9	9	9	9	9	9	9	9	9	9	9
ø	12	12	12	12	12	12	12	12	12	12	12	12	12
i	ALU	56HRC	56HRC	*	HM	HV700	HV700	HV700	*	*	56HRC	HV700	HV700
		x0,2mm	x0,2mm			x0,2mm	x0,2mm	x0,2mm				x0,2mm	x0,2mm
kg	~0,07	~0,12	~0,12	~0,12	~0,12	~0,12	~0,12	~0,14	~0,15	~0,15	~0,12	~0,18	~0,18

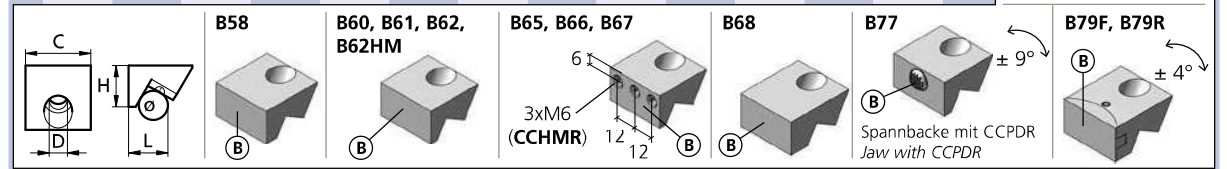
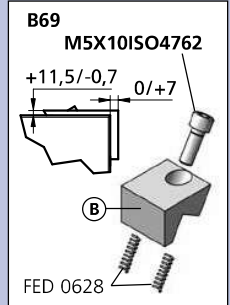

\* = weicher Stahl / soft steel    HM = Hartmetallbeschichtet / Carbide coated    ALU = ENAW-7022

Separat bestellen / Separate order

PS1P48L34-105  
 PS1P48L49-105  
 PS1PF48L49-105

PS1PF48L34-105

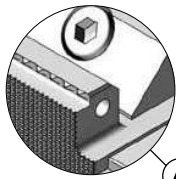
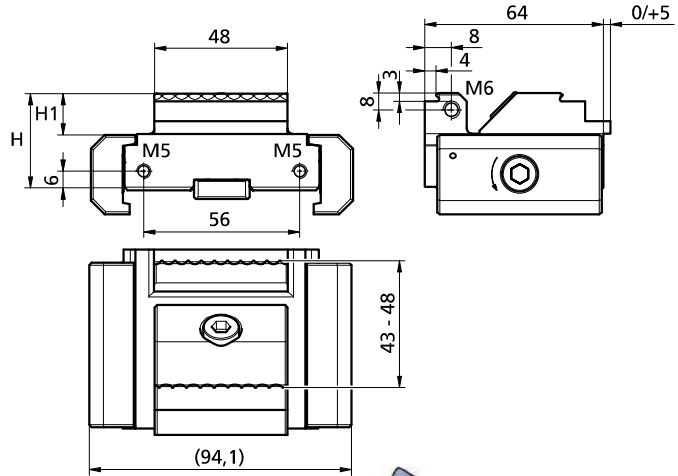
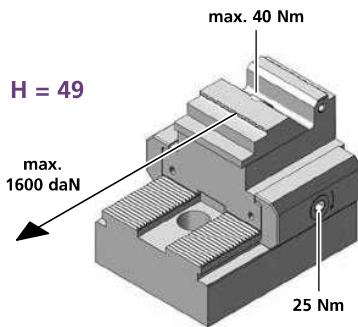
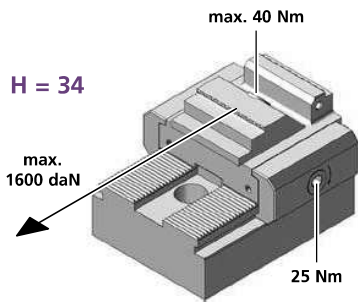

**PS1P48L34-105**

1	1x TW100098-01
2	1x
3	1x PCSP60R
4	1x PCSP60L
5	1x PCS14
6	1x PCGU2059
7	1x M6X8ISO7380
8	2x M5X14ISO4762
9	2x PCD005
10	1x M8X28ISO4762
11	1x PCUSR16
12	2x M5X10ISO4762
13	1x PCKMR45M8
14	2x BN869d=6
H	= 34
H1	= 15
kg	~1,0

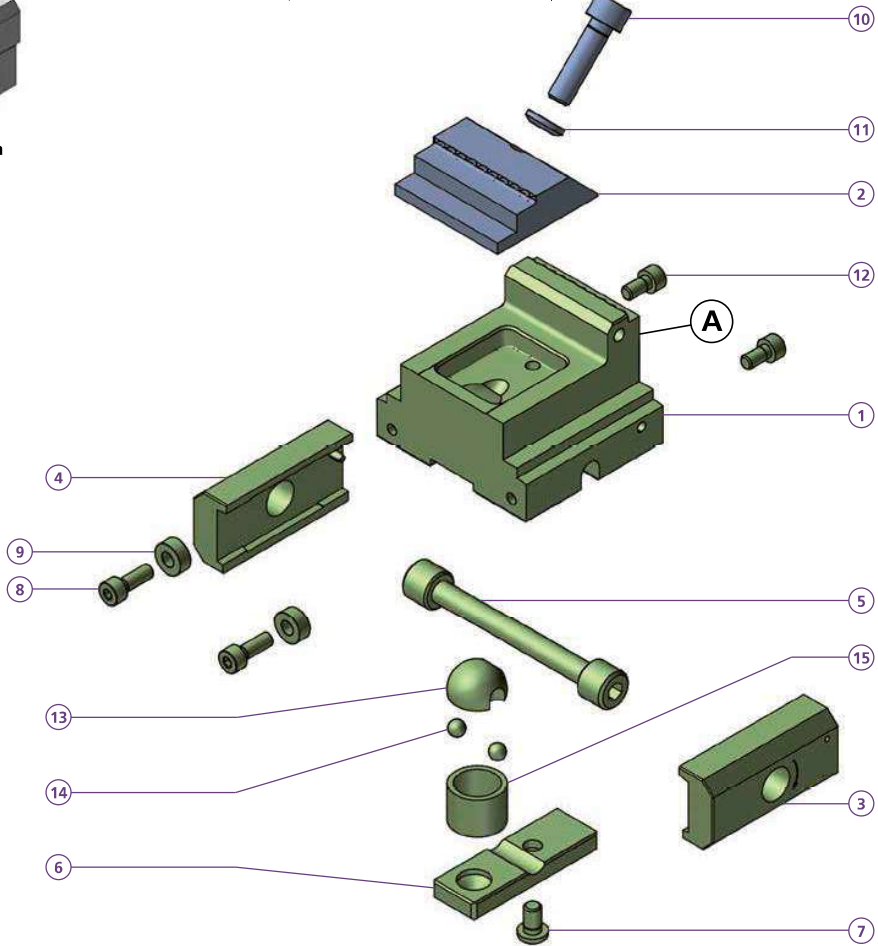

**PS1PF48L34-105**

1	1x TK140780
H	= 34
H1	= 15
kg	~1,0

**PS1P48L49-105**

1	1x TK120011
15	1x PCD20L15
H	= 49
H1	= 30
kg	~1,4

**PS1PF48L49-105**

1	1x TK140781
15	1x PCD20L15
H	= 49
H1	= 30
kg	~1,4

Bestellbeispiel / Ordering example:  
 1x PS1P48L34-105 & 1x B115

Drehmoment Torque		Spannkraft Workholding force		
Nm	(lb-ft)	~daN	~(lb)	~t
10	7,4	= 400	880	0,4
20	14,8	= 800	1'760	0,8
30	22,2	= 1'200	2'650	1,2
40	29,6	= 1'600	3'530	1,6

Separat bestellen / Separate order

PS1P94L34-105

PS1P694L34-105

PS1P94L49-105

PS1PF94L49-105

PS1PF94L34-105

Linear



prägen  
stamping



powerCLAMP

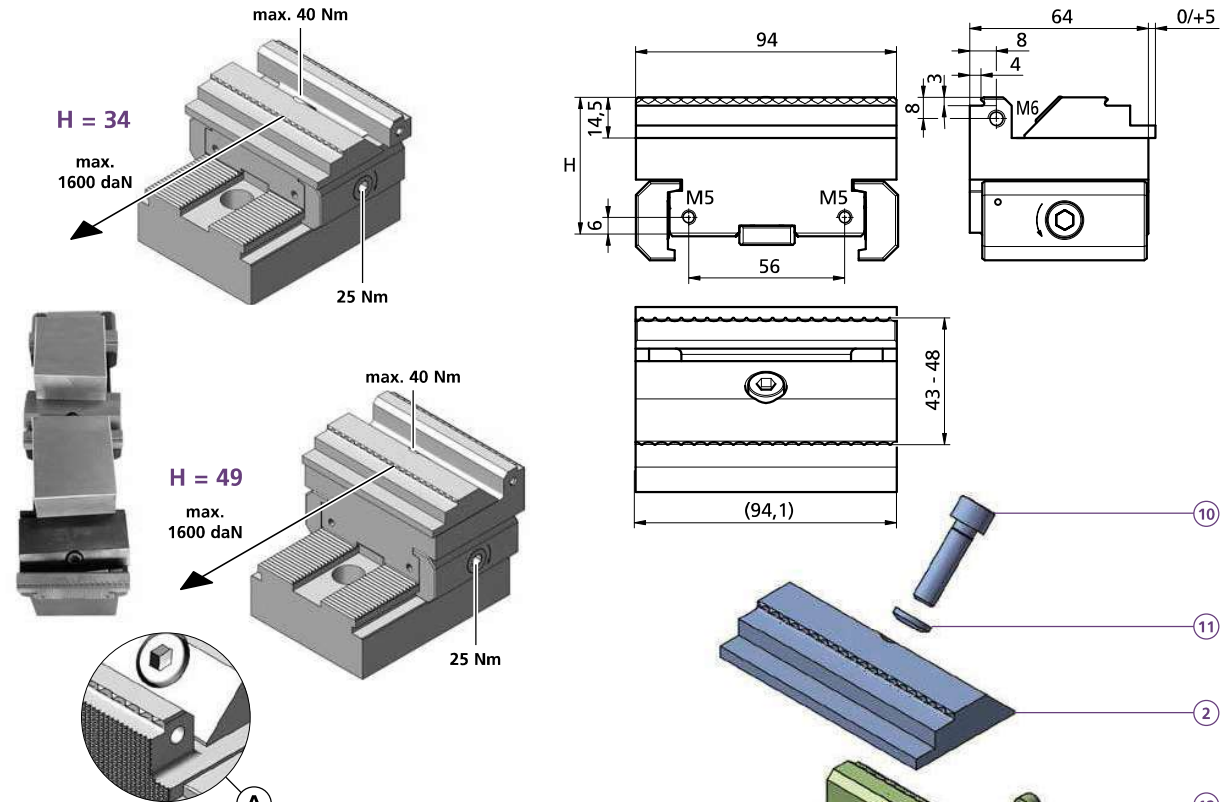

PS1P94L34-105

- 1 1x TW100100-01
- 2 1x
- 3 1x PCSP60R
- 4 1x PCSP60L
- 5 1x PCS14
- 6 1x PCGU2059
- 7 1x M6X8ISO7380
- 8 2x M5X14ISO4762
- 9 2x PCD005
- 10 1x M8X28ISO4762
- 11 1x PCUSR16
- 12 2x M5X10ISO4762
- 13 1x PCKMR45M8
- 14 2x BN869d=6
- H = 34
- kg ~1,1

PS1P694L34-105

- 1 1x TW100100-02
- Y 6,0 mm
- kg ~1,1

PS1PF94L34-105

- 1 1x TK140782
- H = 34
- kg ~1,1

PS1P94L49-105

- 1 1x TK120857
- 15 1x PCD20L15
- H = 49
- kg ~1,8

PS1PF94L49-105

- 1 1x TK140783
- 15 1x PCD20L15
- H = 49
- kg ~1,8

p. 84

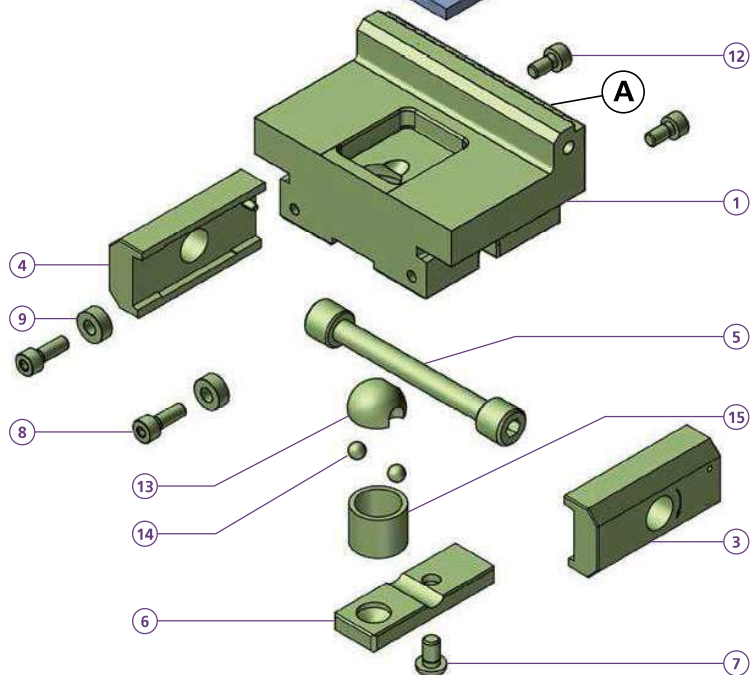

Bestellbeispiel / Ordering example:  
1x PS1P94L34-105 & 1x B120

Drehmoment Torque		Spannkraft Workholding force		
Nm	(lb-ft)	~daN	~(lb)	~t
10	7,4	= 400	880	0,4
20	14,8	= 800	1'760	0,8
30	22,2	= 1'200	2'650	1,2
40	29,6	= 1'600	3'530	1,6

Separat bestellen / Separate order

PS1PV48L34-105  
PS1R/F48L34-105

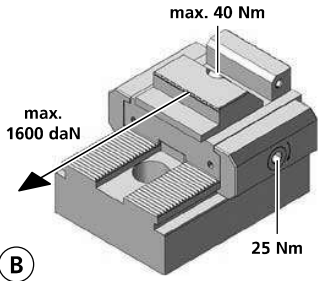
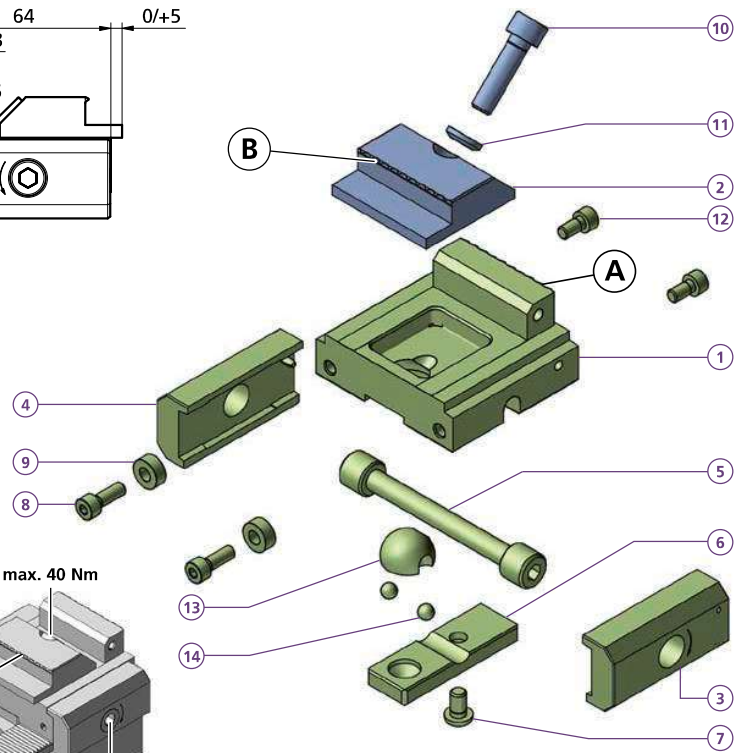
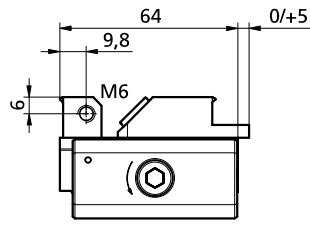
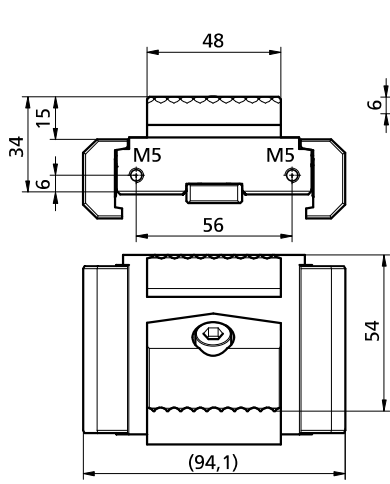

- PS1PV48L34-105**
- 1 1x TK140762
  - 2 1x
  - 3 1x PCSP60R
  - 4 1x PCSP60L
  - 5 1x PCS14
  - 6 1x PCGU2059
  - 7 1x M6X8ISO7380
  - 8 2x M5X14ISO4762
  - 9 2x PCD005
  - 10 1x M8X28ISO4762
  - 11 1x PCUSR16
  - 12 2x M5X10ISO4762
  - 13 1x PCKMR45M8
  - 14 2x BN869d=6
- kg ~1,0

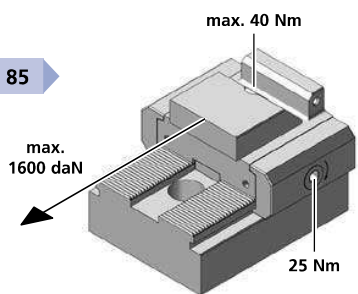
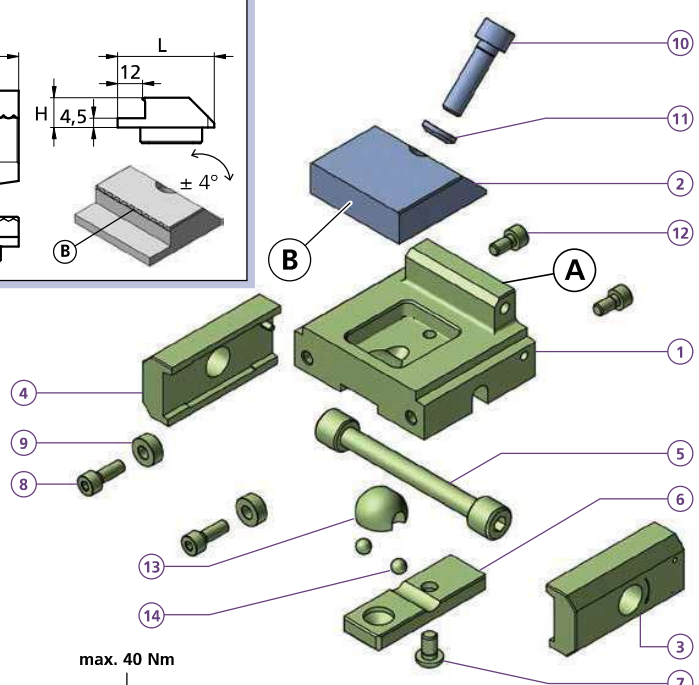
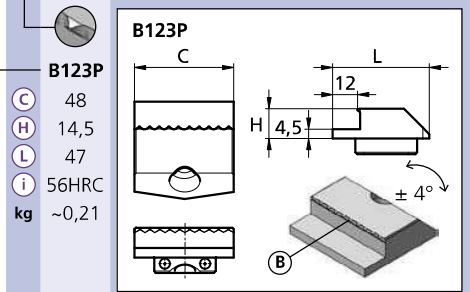

- PS1R48L34-105**
- 1 1x TF140573
- PS1F48L34-105**
- 1 1x TF140572
  - 2 1x
  - 3 1x PCSP60R
  - 4 1x PCSP60L
  - 5 1x PCS14
  - 6 1x PCGU2059
  - 7 1x M6X8ISO7380
  - 8 2x M5X14ISO4762
  - 9 2x PCD005
  - 10 1x M8X30ISO4762
  - 11 1x PCUSR14
  - 12 2x M5X10ISO4762
  - 13 1x PCKMR45M8
  - 14 2x BN869d=6
- kg ~1,0

p. 85

Bestellbeispiel / Ordering example:  
1x PS1R48L34-105 & 1x B123P

Drehmoment Torque		Spannkraft Workholding force		
Nm	(lb-ft)	~daN	~(lb)	~t
10	7,4	= 400	880	0,4
20	14,8	= 800	1'760	0,8
30	22,2	= 1'200	2'650	1,2
40	29,6	= 1'600	3'530	1,6

Separat bestellen / Separate order

PS1R/F78L34-105  
PS1R/F78L49-105

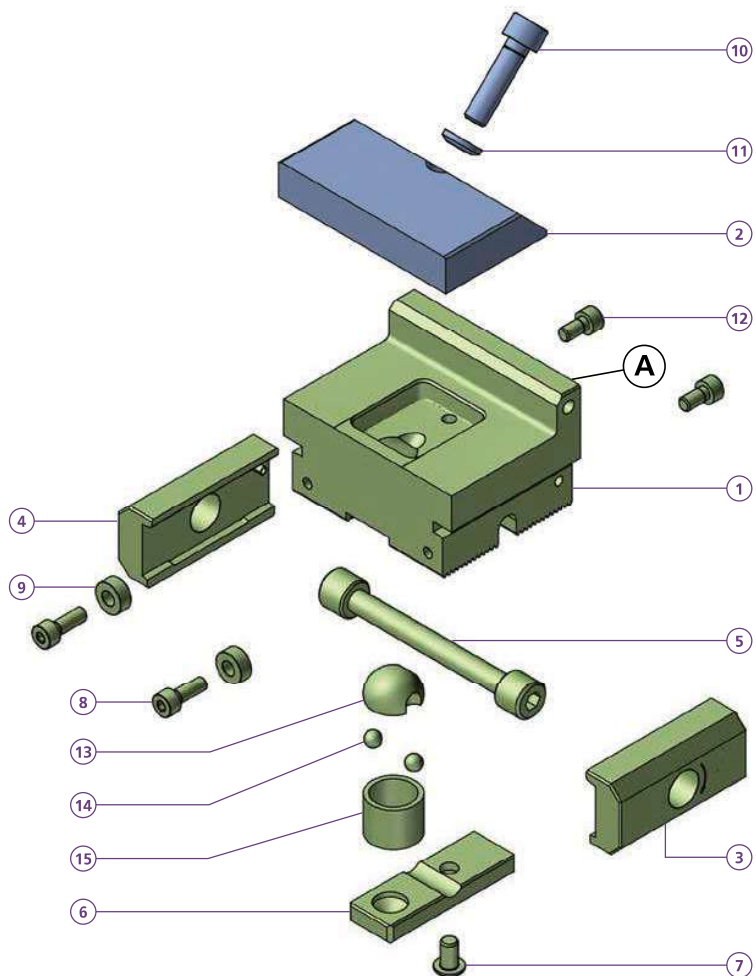
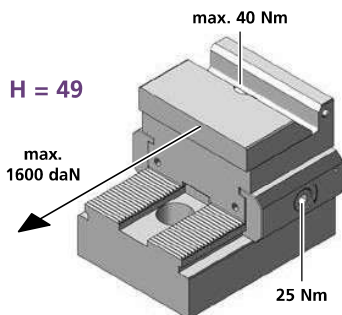
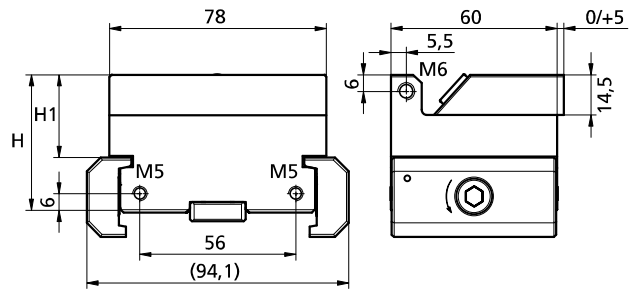
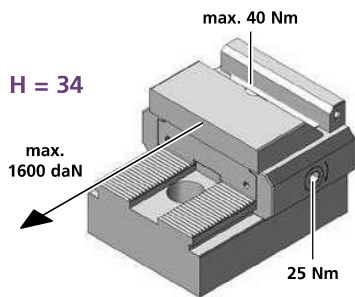

**PS1R78L34-105** 

1 1x TF140575

**PS1F78L34-105** 

1 1x TF140574

2 1x

3 1x PCSP60R

4 1x PCSP60L

5 1x PCS14

6 1x PCGU2059

7 1x M6X8ISO7380

8 2x M5X14ISO4762

9 2x PCD005

10 1x M8X30ISO4762

11 1x PCUSR14

12 2x M5X10ISO4762

13 1x PCKMR45M8

14 2x BN869d=6

H = 34

H1 = 15

kg ~1,0

p. 85

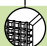
**PS1R78L49-105** 

1 1x TK110399

15 2x PCD20L15

**PS1F78L49-105** 

1 1x TK110400

15 2x PCD20L15

H = 49

H1 = 30

kg ~1,5

Bestellbeispiel / Ordering example:  
1x PS1R48L34-105 & 1x B105

Drehmoment Torque		Spannkraft Workholding force		
Nm	(lb-ft)	~daN	~(lb)	~t
10	7,4	= 400	880	0,4
20	14,8	= 800	1'760	0,8
30	22,2	= 1'200	2'650	1,2
40	29,6	= 1'600	3'530	1,6

Separat bestellen / Separate order

PS1PV94L34-105  
PS1PV94L49-105

Linear



prägen  
stamping



powerCLAMP

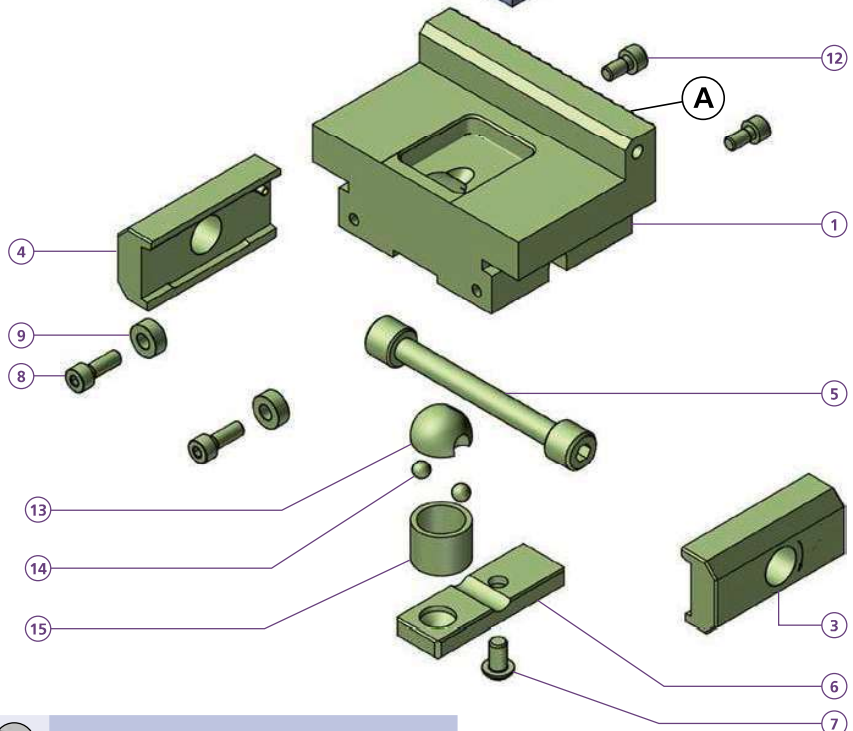
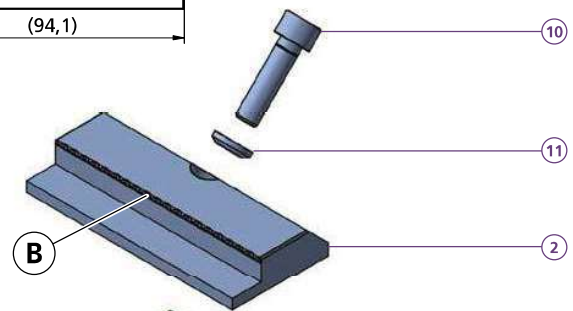
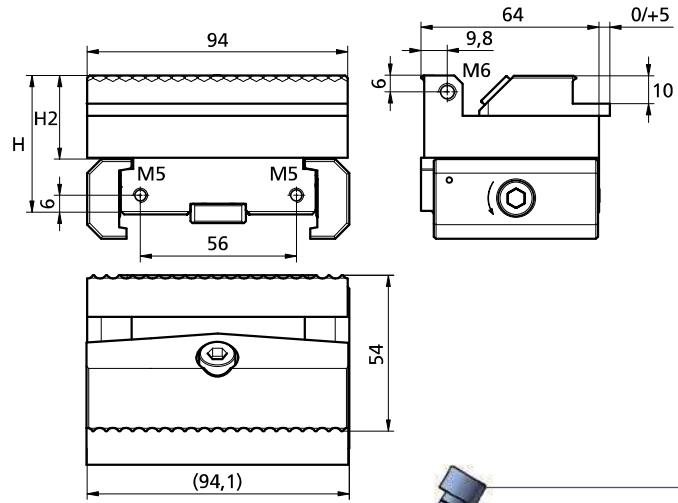
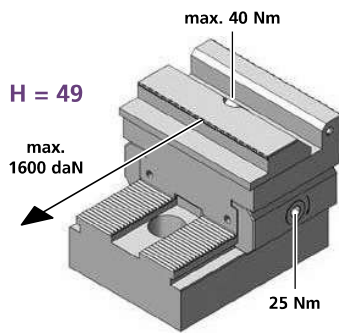
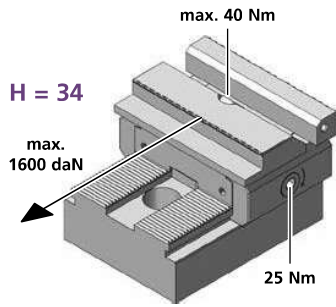

PS1PV94L34-105	
1	1x TK120230
2	1x
3	1x PCSP60R
4	1x PCSP60L
5	1x PCS14
6	1x PCGU2059
7	1x M6X8ISO7380
8	2x M5X14ISO4762
9	2x PCD005
10	1x M8X28ISO4762
11	1x PCUSR16
12	2x M5X10ISO4762
13	1x PCKMR45M8
14	2x BN869d=6
H	= 34
H1	= 15
kg	~1,1

PS1PV94L49-105	
1	1x TK110250
15	1x PCD20L15
H	= 49
H1	= 30
kg	~1,8

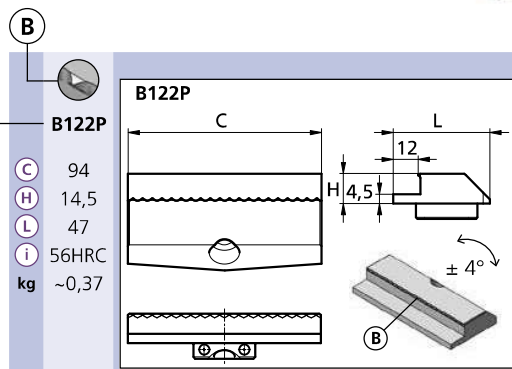

Bestellbeispiel / Ordering example:  
1x PS1PV94L49-105 & 1x B122P

Drehmoment Torque		Spannkraft Workholding force		
Nm	(lb-ft)	~daN	~(lb)	~t
10	7,4	= 400	880	0,4
20	14,8	= 800	1'760	0,8
30	22,2	= 1'200	2'650	1,2
40	29,6	= 1'600	3'530	1,6

Separat bestellen / Separate order

PS1R/F48L49-105  
PS5X48L49-105

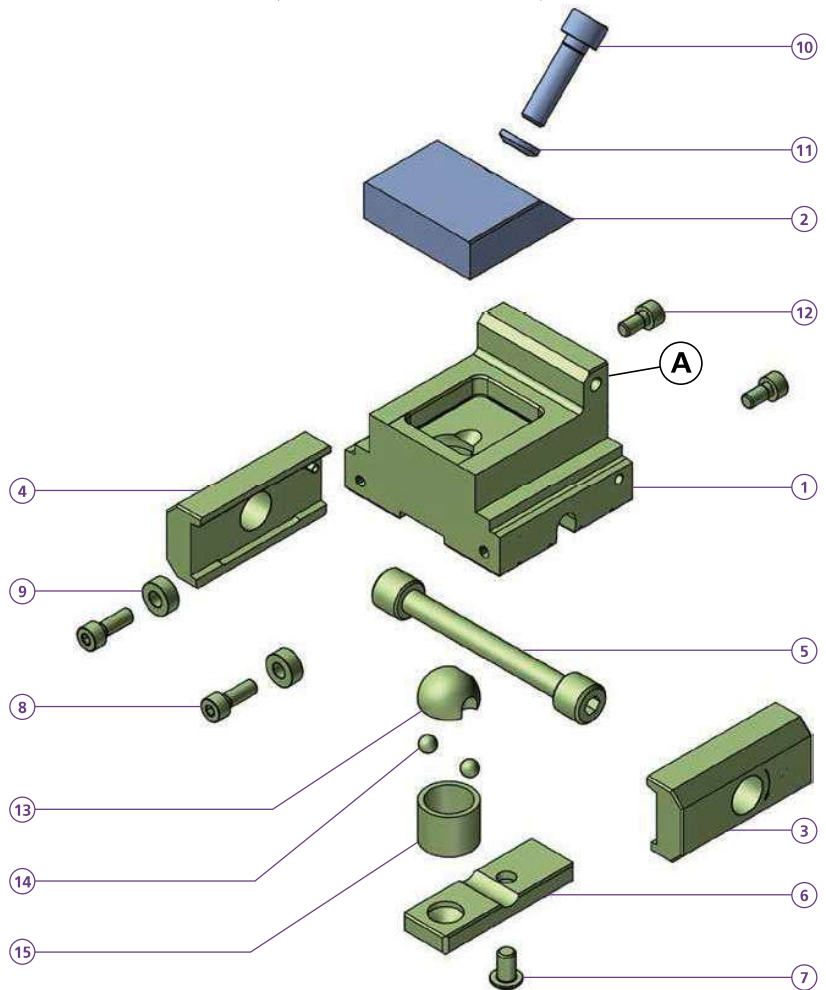
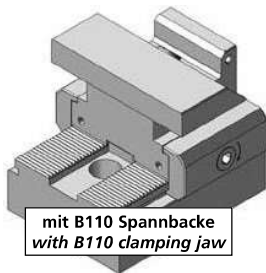
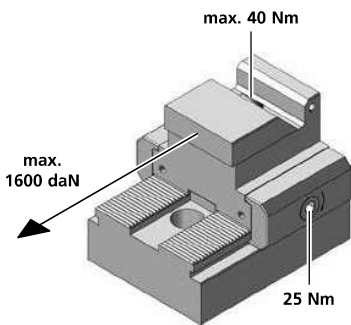
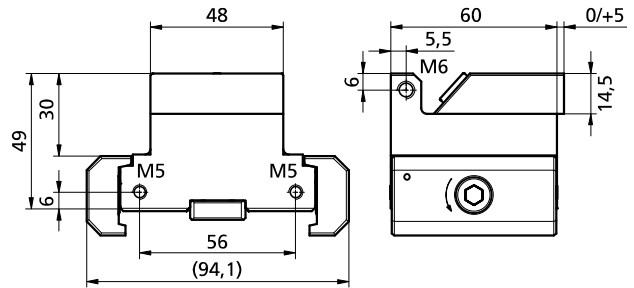
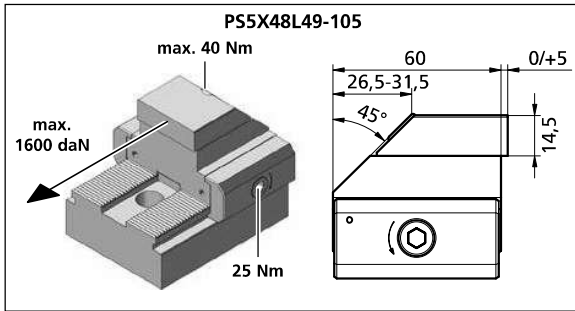

	<b>PS5X48L49-105</b>
1	1x TF190651
9	2x PCD005
8	2x M5X14ISO4762
kg	~1,2
	<b>PS1F48L49-105</b>
1	1x TF140673
	<b>PS1R48L49-105</b>
1	1x TF140672
2	1x <b>p. 85</b>
3	1x PCSP60R
4	1x PCSP60L
5	1x PCS14
6	1x PCGU2059
7	1x M6X8ISO7380
8	2x M5X14ISO4762
9	2x PCD005
10	1x M8X30ISO4762
11	1x PCUSR14
12	2x M5X10ISO4762
13	1x PCKMR45M8
14	2x BN869d=6
15	1x PCD20L15
kg	~1,3

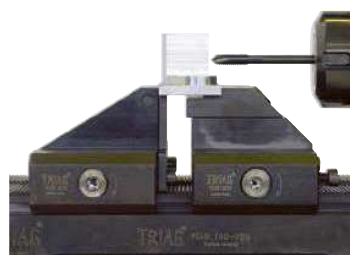

Bestellbeispiel / Ordering example:  
1x PS1F48L49-105 & 1x B105

Drehmoment Torque		Spannkraft Workholding force		
Nm	(lb-ft)	~daN	~(lb)	~t
10	7,4	= 400	880	0,4
20	14,8	= 800	1'760	0,8
30	22,2	= 1'200	2'650	1,2
40	29,6	= 1'600	3'530	1,6

PS5X48L34-105

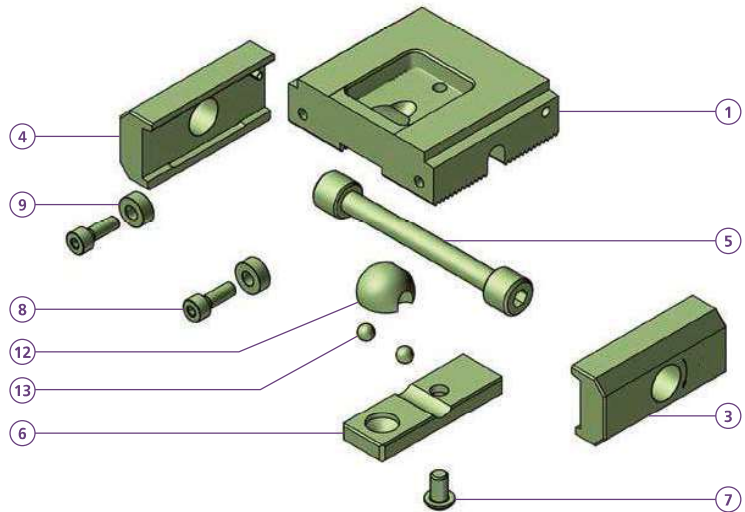
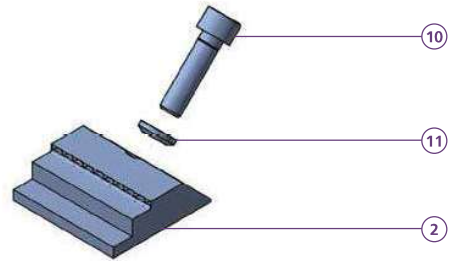
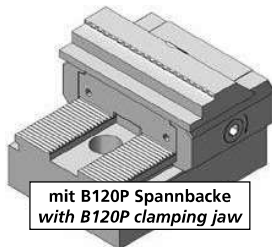
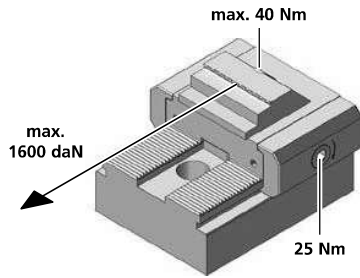
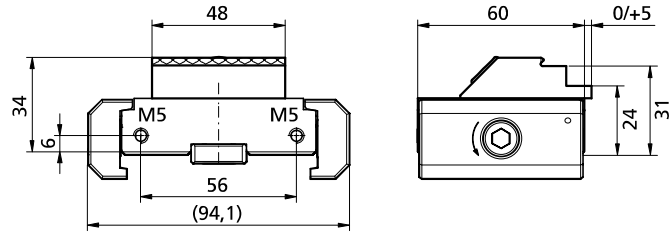

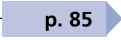
PS5X48L34-105	
1	1x TB210599
2	1x 
3	1x PCSP60R
4	1x PCSP60L
5	1x PCS14
6	1x PCGU2059
7	1x M6X8ISO7380
8	2x M5X14ISO4762
9	2x PCD005
10	1x M8X28ISO4762
11	1x PCUSR16
12	1x PCKMR45M8
13	2x BN869d=6
kg	~0,9

p. 85

Bestellbeispiel / Ordering example:  
1x PS5X48L34-105 & 1x B105

Drehmoment Torque		Spannkraft Workholding force		
Nm	(lb-ft)	~daN	~(lb)	~t
10	7,4	= 400	880	0,4
20	14,8	= 800	1'760	0,8
30	22,2	= 1'200	2'650	1,2
40	29,6	= 1'600	3'530	1,6

Separat bestellen / Separate order



PS1R/F94L34-105  
PS1R/F94L49-105  
PS5X94L49-105

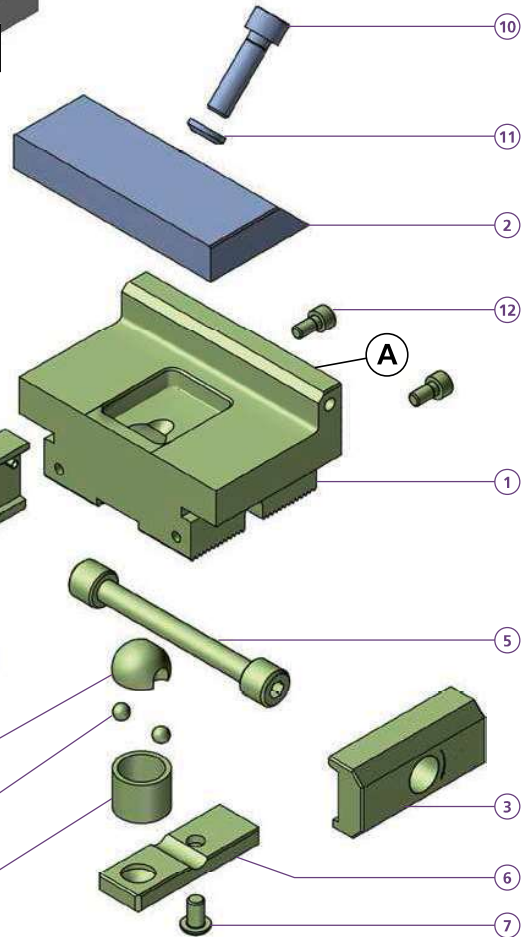
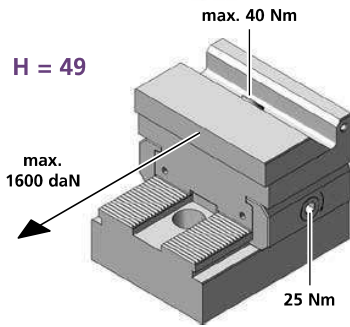
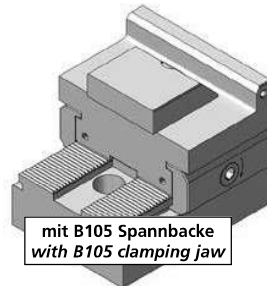
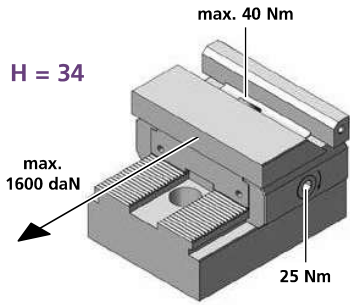
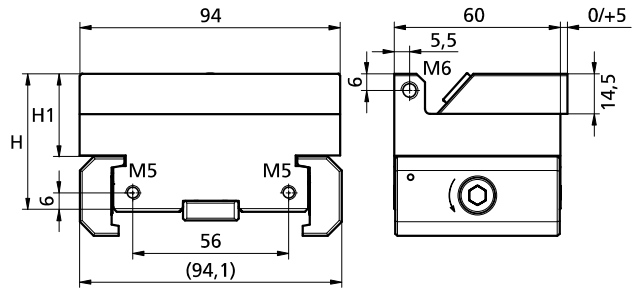
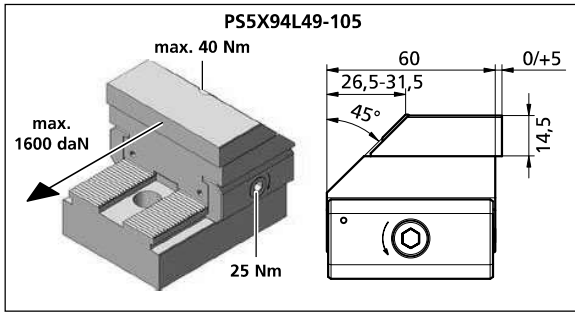

- PS5X94L49-105**
- 1 1x TW100186
  - 15 2x PCD20L15
  - 9 2x PCD005
  - 8 2x M5X14ISO4762
  - kg ~1,5
- PS1F94L34-105**
- 1 1x TH130785
- PS1R94L34-105**
- 1 1x TH130786
  - 2 1x **p. 84**
  - 3 1x PCSP60R
  - 4 1x PCSP60L
  - 5 1x PCS14
  - 6 1x PCGU2059
  - 7 1x M6X8ISO7380
  - 8 2x M5X14ISO4762
  - 9 2x PCD005
- PS1F94L49-105**
- 1 1x TF140674
  - 15 2x PCD20L15
- PS1R94L49-105**
- 1 1x TF140675
  - 15 2x PCD20L15
- H = 34  
H1 = 15  
kg ~1,0

- PS1F94L49-105**
- 1 1x TF140674
  - 15 2x PCD20L15
- PS1R94L49-105**
- 1 1x TF140675
  - 15 2x PCD20L15
- H = 49  
H1 = 30  
kg ~1,7

Bestellbeispiel / Ordering example:  
1x PS1R94L49-105 & 1x B105

Drehmoment Torque		Spannkraft Workholding force		
Nm	(lb-ft)	~daN	~(lb)	~t
10	7,4	= 400	880	0,4
20	14,8	= 800	1'760	0,8
30	22,2	= 1'200	2'650	1,2
40	29,6	= 1'600	3'530	1,6

Separat bestellen / Separate order

PS1R48L49-105H20

PS1R94L49-105H20

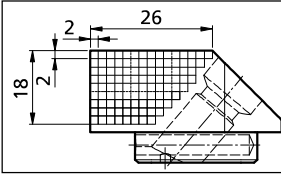

**Zum Erstellen Ihrer individuellen Formbacke: *If a dedicated jaw is being machined:***  
Schnittzeichnung zum Ermitteln der maximalen Bearbeitungsprofiltiefe *Sectional drawing to determine the maximum machining depth*

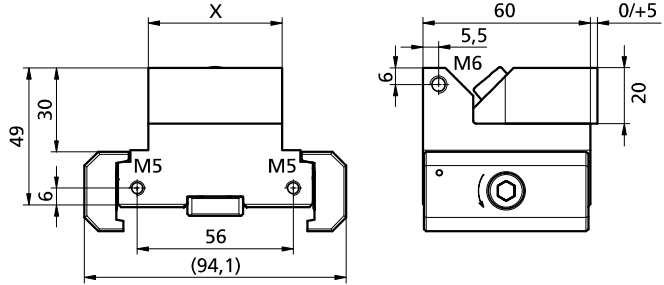
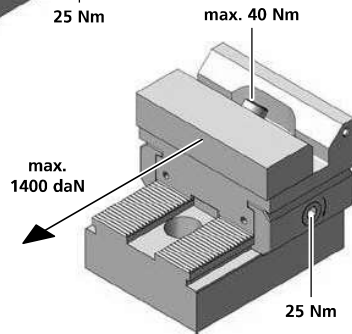
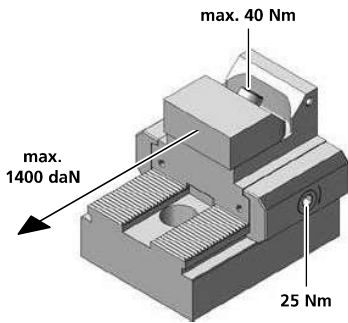

PS1R48L49-105H20	
1	1x TW100161-01
2	1x
3	1x PCSP60R
4	1x PCSP60L
5	1x PCS14
6	1x PCGU2059
7	1x M6X8ISO7380
8	2x M5X14ISO4762
9	2x PCD005
10	1x M8X35ISO4762
11	1x PCUSR14
12	2x M5X10ISO4762
13	1x PCKMR45M8
14	2x BN869d=6
15	1x PCD20L095
X	= 48
kg	~1,2

PS1R94L49-105H20	
1	1x TW100161-07
X	= 94
kg	~1,5

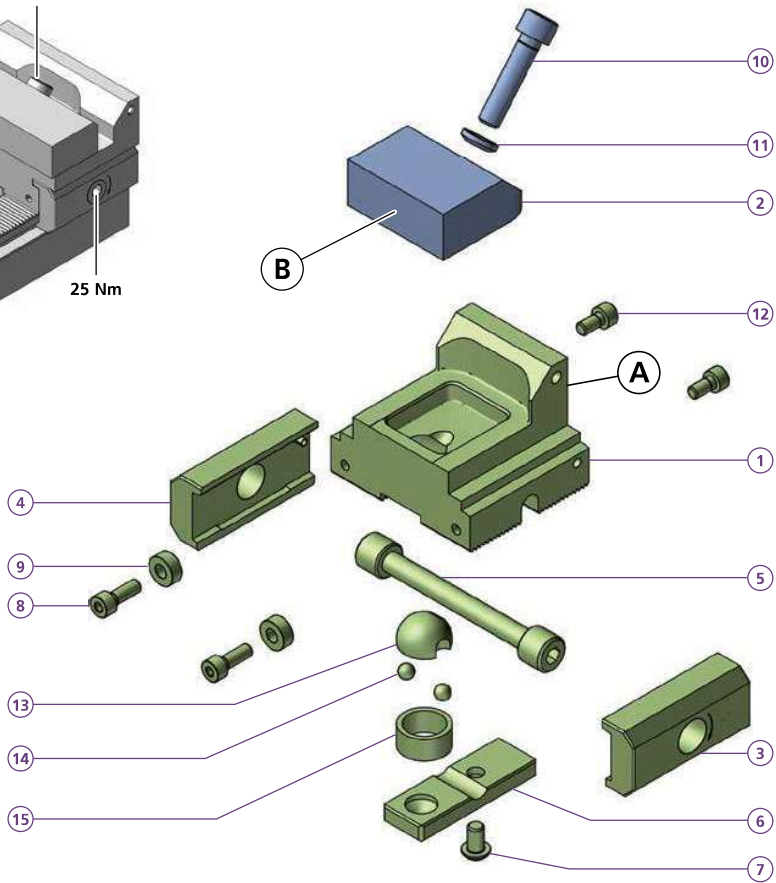

**Bestellbeispiel / Ordering example:** 1x PS1R48L49-105H20 & 1x B107H20

	B105H20	B106H20	B107H20	B110H20	B111H20	B112H20
C	48	48	48	94	94	94
H	20	20	20	20	20	20
L	47	47	47	47	47	47
i	HV700	HV700	*	HV700	HV700	*
	x0,2mm	x0,2mm		x0,2mm	x0,2mm	
kg	~0,38	~0,38	~0,38	~0,57	~0,56	~0,56

B105H20, B106H20, B107H20		B110H20, B111H20, B112H20	
			
C		L	
H		H	

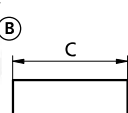
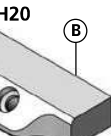
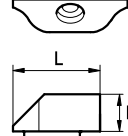
Separat bestellen / Separate order

PS1R125L49-105H20

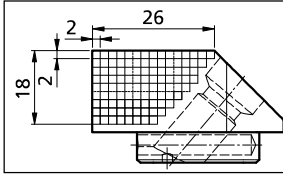

**Zum Erstellen Ihrer individuellen Formbacke: *If a dedicated jaw is being machined:***  
Schnittzeichnung zum Ermitteln der maximalen Bearbeitungsprofiltiefe *Sectional drawing to determine the maximum machining depth*

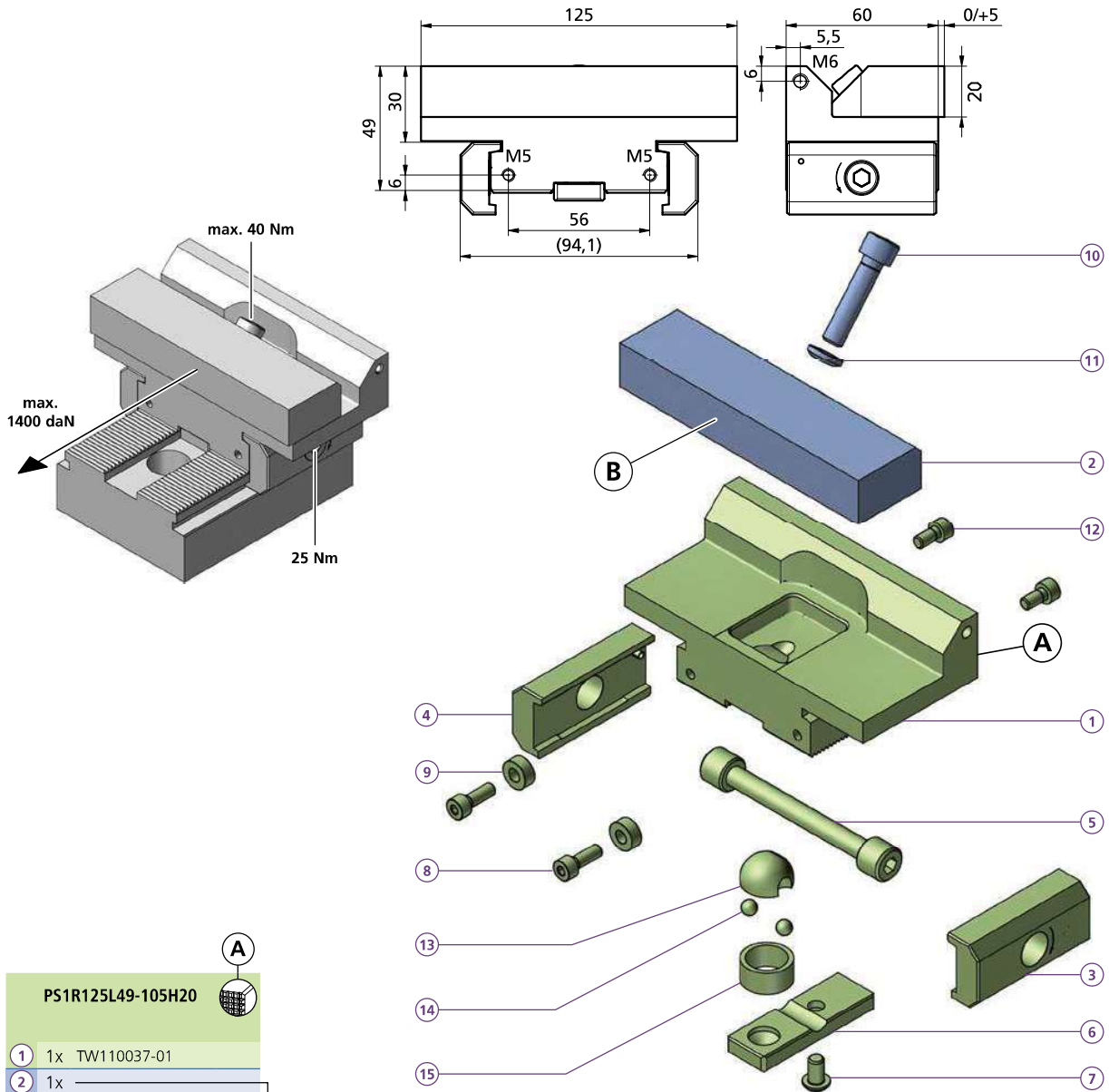

**PS1R125L49-105H20**

1	1x	TW110037-01
2	1x	
3	1x	PCSP60R
4	1x	PCSP60L
5	1x	PCS14
6	1x	PCGU2059
7	1x	M6X8ISO7380
8	2x	M5X14ISO4762
9	2x	PCD005
10	1x	M8X35ISO4762
11	1x	PCUSR14
12	2x	M5X10ISO4762
13	1x	PCKMR45M8
14	2x	BN869d=6
15	1x	PCD20L095
kg		~1,7

**Bestellbeispiel / Ordering example: 1x PS1R125L49-105H20 & 1x B132H20P**

	B130H20P	B131H20P	B132H20P
C	125	125	125
H	20	20	20
L	47	47	47
i	HV700	HV700	*
	x0,2mm	x0,2mm	
kg	~0,71	~0,71	~0,71

**B130H20P, B131H20P, B132H20P**

\* = weicher Stahl / soft steel

Separat bestellen / Separate order

# Linear-Spannbacken ... Linear clamping jaw ...

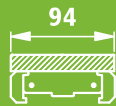

powerCLAMP

mit Prägeeinsätzen  
with direct-stamping inserts

Art. Nr.	kg
<b>B110P-PRGM8</b>	~0,46

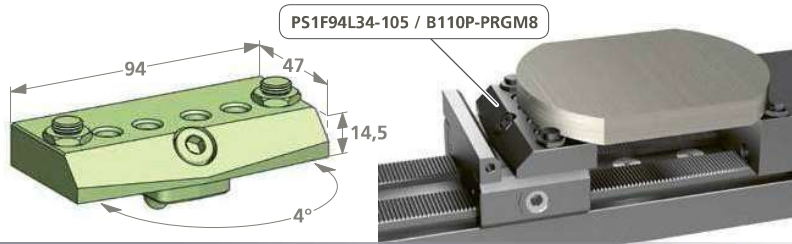

zum Einsatz in unterschiedlichen Spannsituationen  
for use in different clamping situations

Art. Nr.	i	kg
<b>B110</b>	HV700 x0,2mm	~0,49
<b>B110P</b>	HV700 x0,2mm	~0,49
<b>B111</b>	HV700 x0,2mm	~0,48
<b>B111P</b>	HV700 x0,2mm	~0,48
<b>B112</b>	weicher Stahl soft steel	~0,49
<b>B112P</b>	weicher Stahl soft steel	~0,49
<b>B112HG</b>	Hochgenau High-precision	~0,49
<b>B112E</b>	Einsatzstahl Case hardening steel	~0,49
<b>B112EP</b>	Einsatzstahl Case hardening steel	~0,47
<b>B113</b>	HV700 x0,2mm	~0,39
<b>B113P</b>	HV700 x0,2mm	~0,39
<b>B117P</b>	57HRC	~0,46
<b>B120</b>	57HRC	~0,4
<b>B120P</b>	57HRC	~0,4

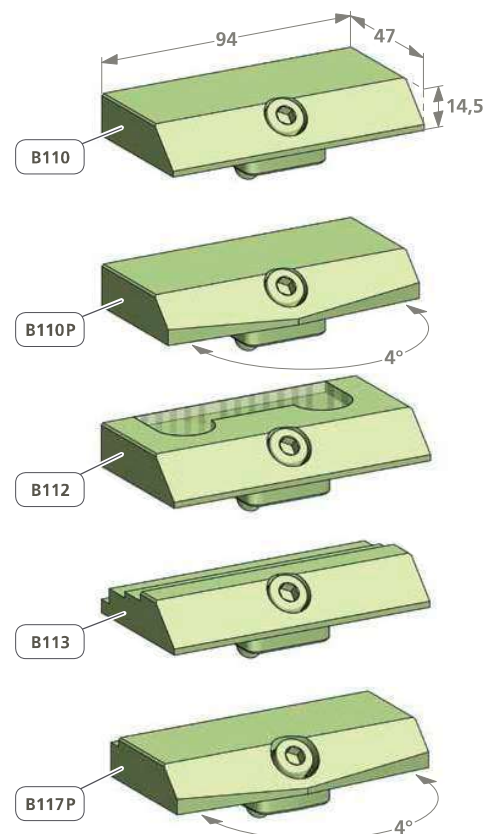

## Modulhöhen / Module heights 34 / 49 mm

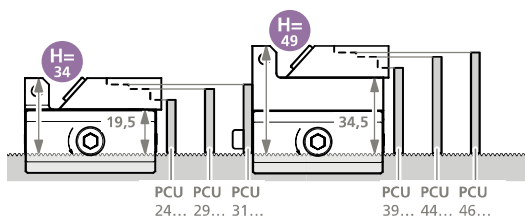

Beim Einsatz einer Stufenbacke, ist die richtige Modulspannhöhe 34 mm/49 mm zu berücksichtigen. Die Werkstücke auf der Anschlagseite werden mit den passenden Parallelunterlagen abgestützt.

When using a step jaw is applied, the correct module clamping height 34 mm/49 mm must be taken into account. The workpieces on the end module are supported with the appropriate steel parallel.

## Eingesetzte Stufenbacken / Inserted stepped jaws (B113)

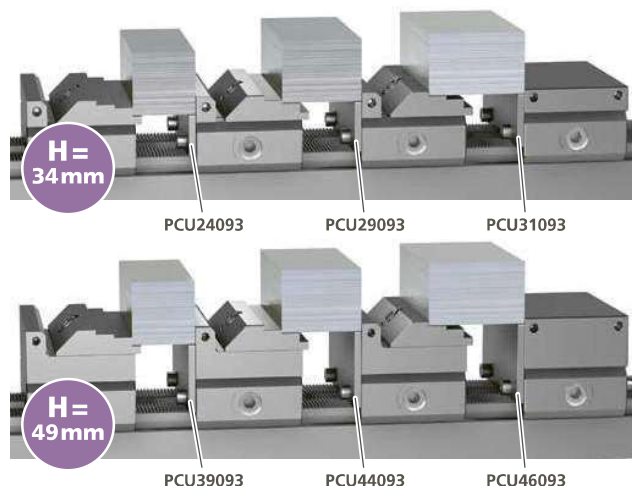

# Linear-Spannbacken ... Linear clamping jaw ...



powerCLAMP

zum Einsatz in unterschiedlichen Spannsituationen  
for use in different clamping situations

Art. Nr.				kg
<b>B140</b>	HV700 x0,2mm			~0,41
<b>B140P</b>	HV700 x0,2mm			~0,41
<b>B141</b>	HV700 x0,2mm			~0,41
<b>B141P</b>	HV700 x0,2mm			~0,41
<b>B105</b>	HV700 x0,2mm			~0,27
<b>B105P</b>	HV700 x0,2mm			~0,27
<b>B105-15</b>	HV700 x0,2mm			~0,27
<b>B106</b>	HV700 x0,2mm			~0,27
<b>B106P</b>	HV700 x0,2mm			~0,27
<b>B107</b>	weicher Stahl soft steel			~0,27
<b>B107P</b>	weicher Stahl soft steel			~0,27
<b>B108</b>	HV700 x0,2mm			~0,22
<b>B108P</b>	HV700 x0,2mm			~0,22
<b>B115</b>	57HRC			~0,21
<b>B115P</b>	57HRC			~0,21
<b>B116P</b>	57HRC			~0,25

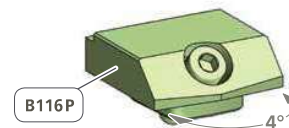
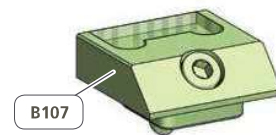
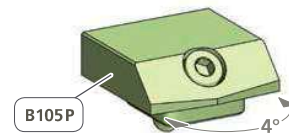
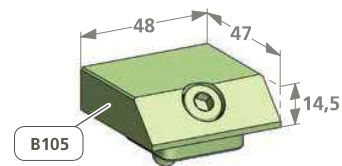
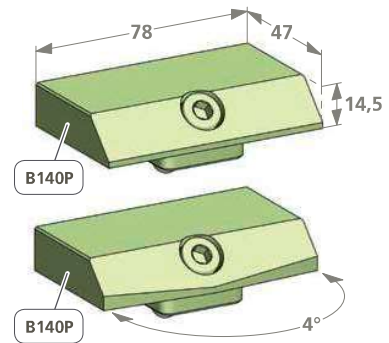

Bei allen Prägebacken kann die Kräftehaltung mit den nachfedernden Tellerfedern eingesetzt werden um ein Freiwegeln des Werkstücks zu verhindern.

On every spring loaded stamping jaw, the force retention with the disc springs can be used to prevent the workpiece from wiggeling free.

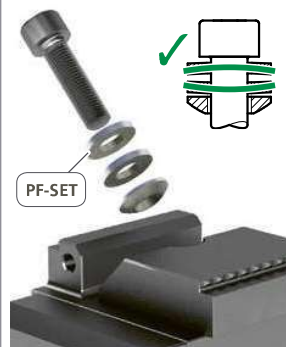

Die Tellerfedern werden gegenläufig montiert.

The disc springs are mounted in opposite directions.

## Für Prägebacken / For stamping jaws

**PF-SET** Kräftehaltung mit Nachfederung  
Spring loaded mechanism to maintain clamping force

## Modulhöhen / Module heights 34 / 49 mm

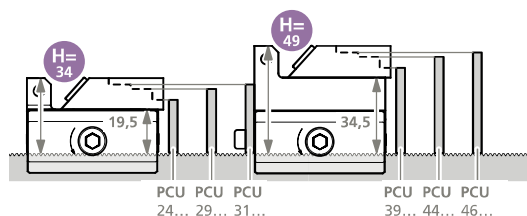

Beim Einsatz einer Stufenbacke, ist die richtige Modulspannhöhe 34 mm/49 mm zu berücksichtigen. Die Werkstücke auf der Anschlagseite werden mit den passenden Parallelunterlagen abgestützt.

When using a step jaw is applied, the correct module clamping height 34 mm/49 mm must be taken into account. The workpieces on the end module are supported with the appropriate steel parallel.

## Eingesetzte Stufenbacken / Inserted stepped jaws (B108)



# Anschlagmodule ... End module ...

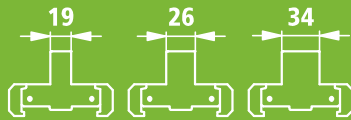

powerCLAMP

für die horizontale und vertikale Bearbeitung  
for horizontal and vertical machining

Art. Nr.	kg	X
<b>PAND19-49</b>	~1,2	19
<b>PAND26-49</b>	~1,3	26
<b>PAND34-49</b>	~1,6	34

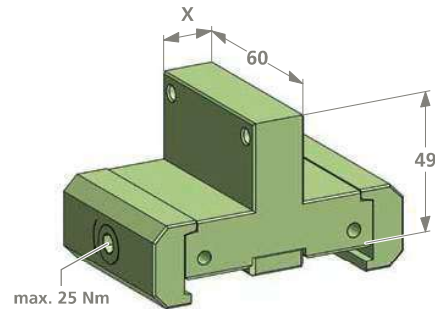

Schmale Anschlagmodule für schmale  
Werkstücke in der Mehrfachspannung.  
Slim stop modules for slim workpieces  
in multiple workholding.

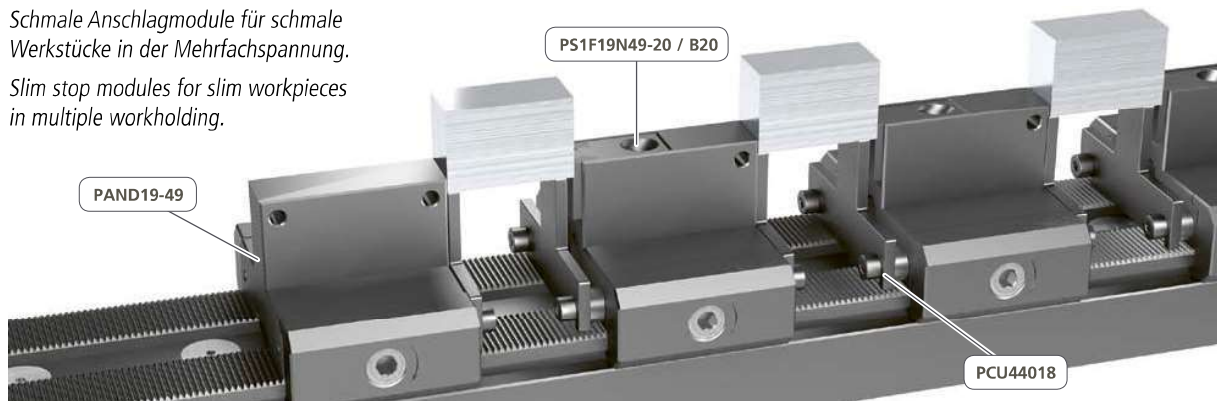

## 5-Achs Maschine 5-axis machine

Art. Nr.	kg	X
<b>PA5X19-49R</b>	~1,1	19
<b>PA5X19-49F</b>	~1,1	19
<b>PA5X26-49R</b>	~1,2	26
<b>PA5X26-49F</b>	~1,2	26
<b>PA5X34-49R</b>	~1,3	34
<b>PA5X34-49F</b>	~1,3	34

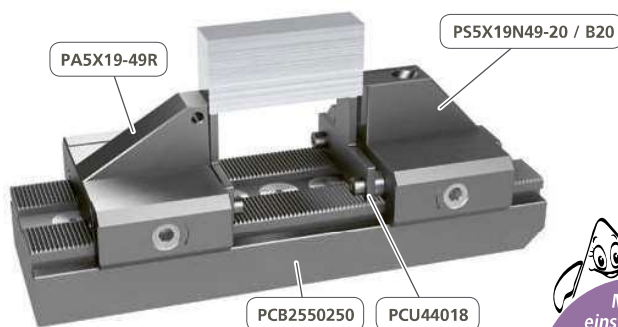
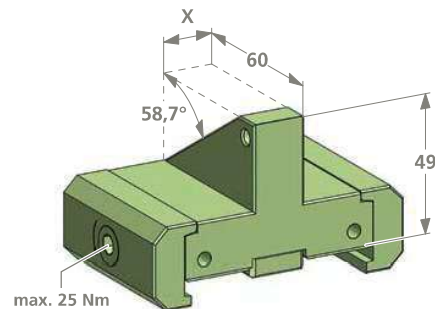

Schmales 5-Achs Anschlagmodul & Spannmodul  
für schmale Werkstücke auf einer Basisschiene.  
Slim 5-axis end module & clamping module for  
slim workpieces on a base rail.

Module  
einsetzbar auf  
Zentrischspanner  
oder Basisschiene.  
Modules  
can be used on self  
centrig vise ore  
base rail.



Schmale 5-Achs Anschlagmodule für schmale  
Werkstücke auf einem ZSM Zentrischspanner.  
Slim 5-axis end modules for slim workpieces  
on a ZSM self centering vises.

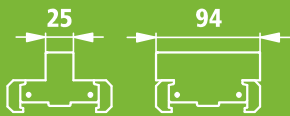

powerCLAMP

**Anschlagmodule für die horizontale und vertikale Bearbeitung**  
*End modules for horizontal and vertical machining*

Art. Nr.	kg
<b>PAND25-44</b>	~0,9

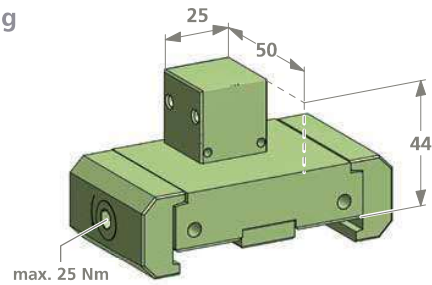
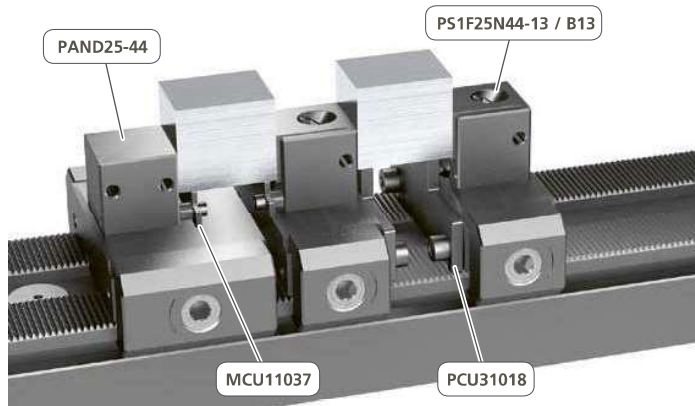

*Schlankes und kurzes Anschlagmodul für Kleinteil-Serien (Mehrfachspannung).*  
*Slim and short end module for small part series (Multiple workholding).*

Art. Nr.	kg
<b>PAND94-44</b>	~1,3



*Die Anschlagfläche ist mit einer punktuellen Anschlagfunktion ausgestattet. Die dafür benötigte Passbohrungen M5/5f7 ist mittig platziert. Benötigtes Zubehör: MS50.*

*The stop surface is equipped with a punctual stop function. The required fitting holes M5/5f7 are placed in the center. Required accessories: MS50.*

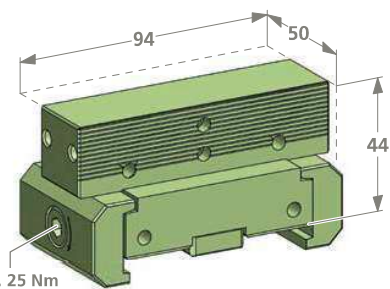

*Breites Anschlagmodul mit Doppelspannfunktion. Verdoppelt die Anzahl Spannbereiche auf gleichbleibendem Raum.*

*Wide end module with double clamping function. Doubles the number of clamping areas in the same amount of working space.*

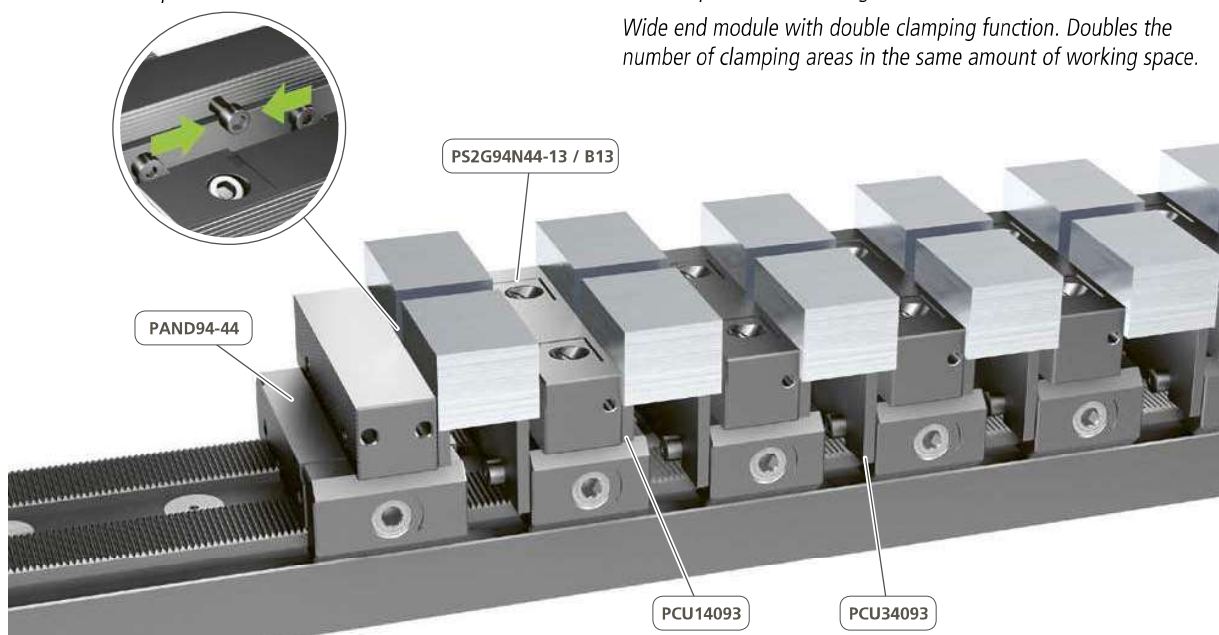

SCAN OR CLICK



PDF



STEP

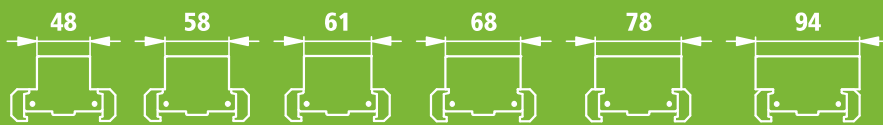

powerCLAMP

**Anschlagmodule für die horizontale und vertikale Bearbeitung**  
*End modules for horizontal and vertical machining*

Art. Nr.		kg	X	H
<b>PAND48-34</b>		~1,3	48	34
<b>PAND48-75</b>		~2,2	48	75
<b>PAND58-34</b>		~1,4	58	34
<b>PAND58-49</b>		~1,8	58	49

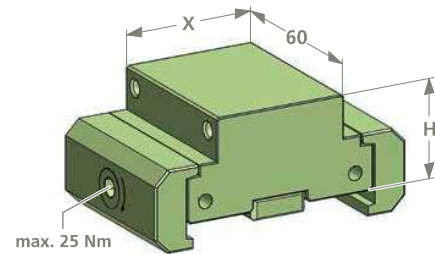

48 mm bis 94 mm breite Anschlagmodule für die Einzel- und Mehrfachspannung.  
 48 mm to 94 mm wide end modules for single and multiple clamping.

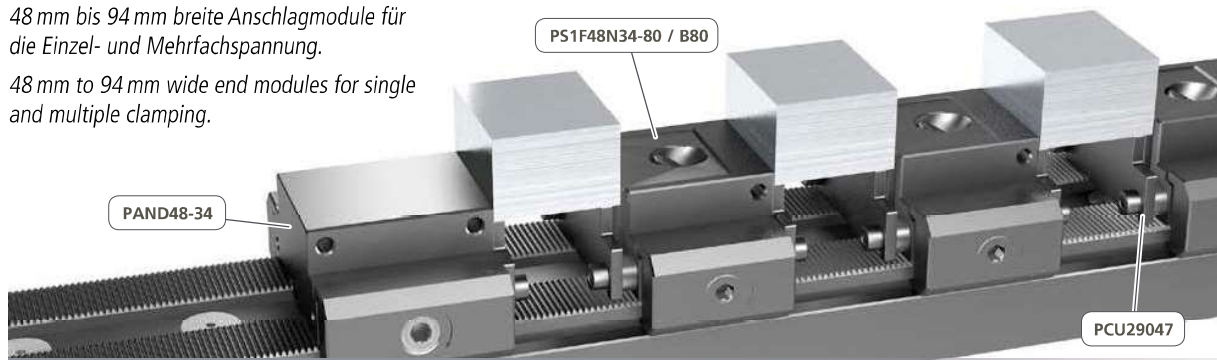

Art. Nr.		kg	X	H
<b>PAND61-34</b>		~1,4	61	34
<b>PAND68-34</b>		~1,4	68	34
<b>PAND78-34</b>		~1,5	78	34
<b>PAND78-49</b>		~2,0	78	49
<b>PAND94-34</b>		~2,3	94	34

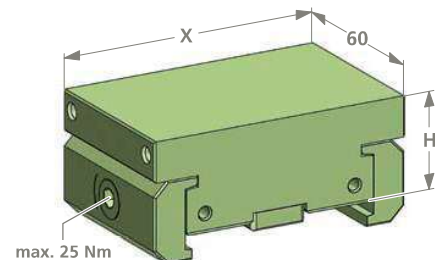

61 mm bis 94 mm breite Anschlagmodule für die Einzel- und Mehrfachspannung.  
 61 mm to 94 mm wide end modules for single and multiple clamping.

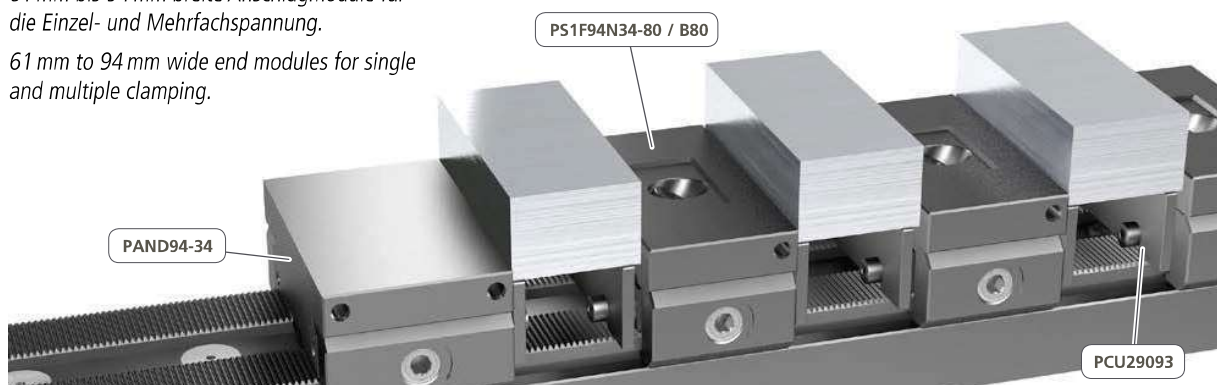



PAND43-49  
PAND48-49  
PAND94-49

PAND125-49  
PA5X43-49R/F  
PA5X48-49R/F

PA5X94-49R/F  
PA5X125-49R/F



powerCLAMP

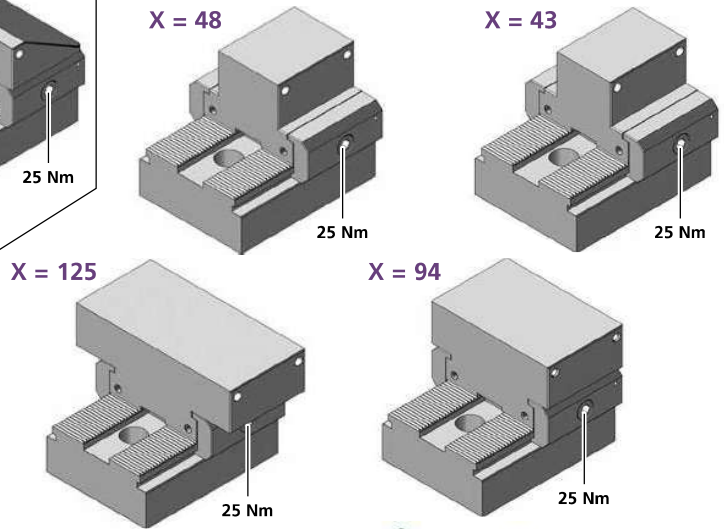
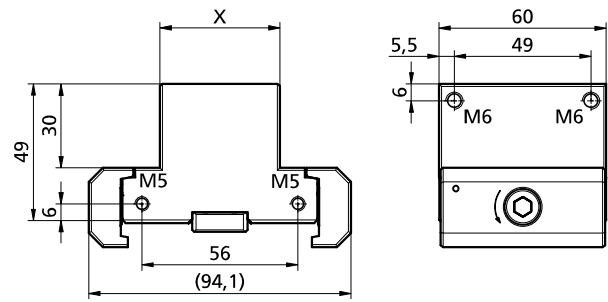
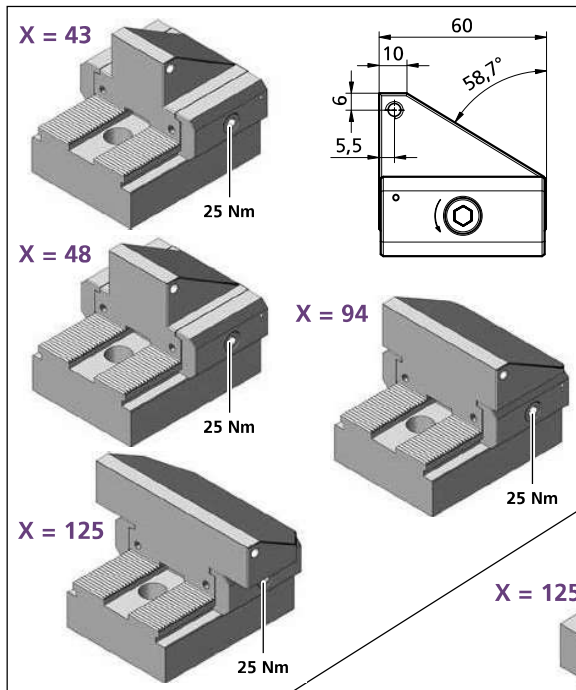

	<b>PA5X43-49R</b>	
<b>1</b>	1x TF140651	
<b>12</b>	2x M5X10ISO4762	
	<b>PA5X43-49F</b>	
<b>1</b>	1x TF140652	
<b>12</b>	2x M5X10ISO4762	
kg	~1,3	
	<b>PAND43-49</b>	
<b>1</b>	1x TF140659	
<b>3</b>	1x PCSP60R	
<b>4</b>	1x PCSP60L	
<b>5</b>	1x PCS14	
<b>6</b>	1x PCGU2049	
<b>7</b>	1x M6X8ISO7380	
<b>12</b>	4x M5X10ISO4762	
X	= 43	
kg	~1,6	
	<b>PA5X48-49R</b>	
<b>1</b>	1x TF140653	
<b>12</b>	2x M5X10ISO4762	
	<b>PA5X48-49F</b>	
<b>1</b>	1x TF140654	
<b>12</b>	2x M5X10ISO4762	
kg	~1,3	
	<b>PAND48-49</b>	
<b>1</b>	1x TF140660	
X	= 48	
kg	~1,6	

Bestellbeispiel / Ordering example:  
PAND43-49

	<b>PA5X94-49R</b>	
<b>1</b>	1x TF140655	
<b>12</b>	2x M5X10ISO4762	
	<b>PA5X94-49F</b>	
<b>1</b>	1x TF140656	
<b>12</b>	2x M5X10ISO4762	
kg	~1,7	
	<b>PAND94-49</b>	
<b>1</b>	1x TB150451	
X	= 94	
kg	~2,3	

	<b>PA5X125-49R</b>	
<b>1</b>	1x TF140657	
<b>12</b>	2x M5X10ISO4762	
	<b>PA5X125-49F</b>	
<b>1</b>	1x TF140658	
<b>12</b>	2x M5X10ISO4762	
kg	~2,0	
	<b>PAND125-49</b>	
<b>1</b>	1x TF140662	
X	= 125	
kg	~2,7	

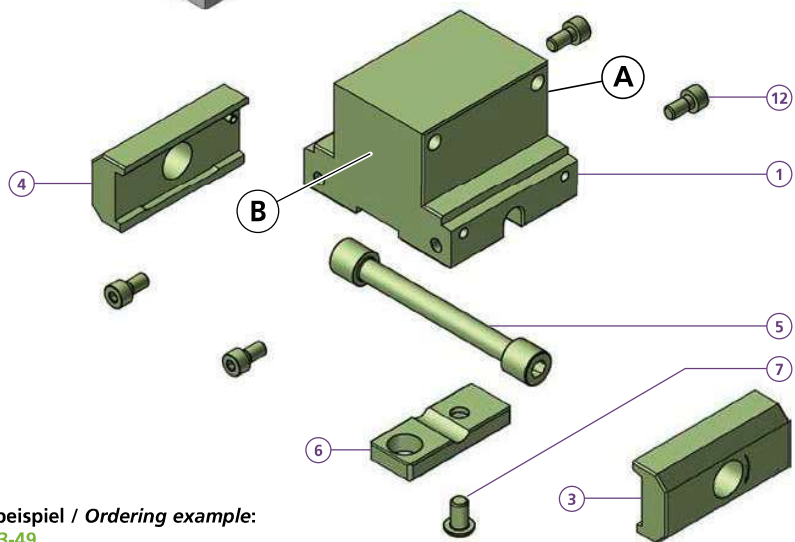

**PAND48-34PRG/F-A1**  
**PAND48-49PRG/F-A1**  
**PAND94-34PRG/F-A1**



**PAND94-49PRG/F-A1**  
**PAND125-49PRG-A1**





prägen  
stamping



**powerCLAMP**

**PAND48-34PRG-A1**   



① 1x TH120684

**PAND48-34PRF-A1**   

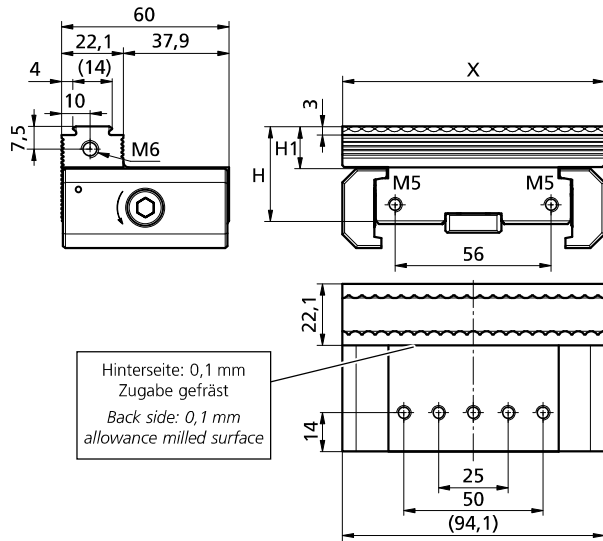
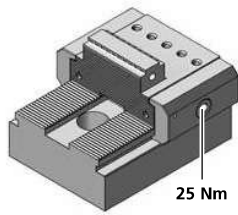

① 1x TK140239  
 ③ 1x PCSP60R  
 ④ 1x PCSP60L  
 ⑤ 1x PCS14  
 ⑥ 1x PCGU2049  
 ⑦ 1x M6X8ISO7380  
 ⑫ 4x M5X10ISO4762

X = 48  
 H = 34  
 H1 = 15  
 kg ~1,1



**PAND48-49PRG-A1**   



① 1x TH120685

**PAND48-49PRF-A1**   

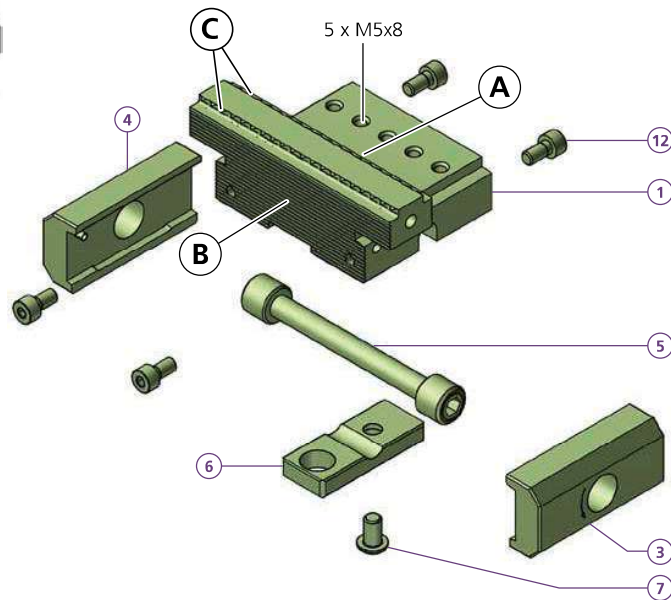
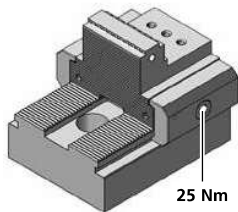

① 1x TK140597

X = 48  
 H = 49  
 H1 = 30  
 kg ~1,3



**PAND94-34PRG-A1**   



① 1x TH120686

**PAND94-34PRF-A1**   

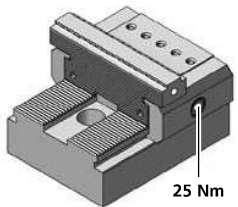

① 1x TH140185

X = 94  
 H = 34  
 H1 = 15  
 kg ~1,2



**PAND94-49PRG-A1**   



① 1x TH120687

**PAND94-49PRF-A1**   

① 1x TH130754

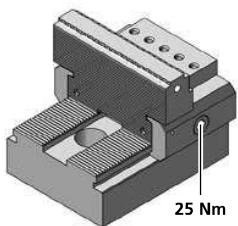
X = 94  
 H = 49  
 H1 = 30  
 kg ~1,6



**PAND125-49PRG-A1**   

① 1x TB160295

X = 125  
 H = 49  
 H1 = 30  
 kg ~1,7

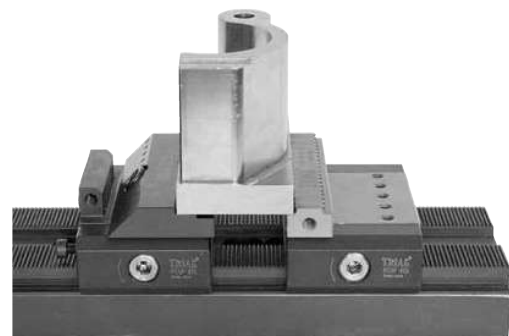
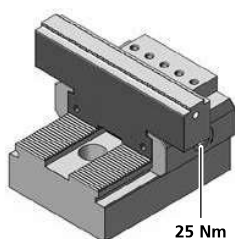

Bestellbeispiel / Ordering example: **PAND94-34PRG-A1**

**PAND125-34PRG-A1**  
**PAND150-34PRG-A1**  
**PAND94-34PRGV**



prägen  
stamping



**powerCLAMP**

X = 125

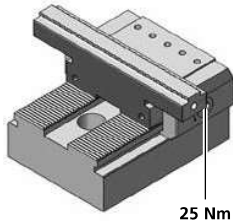

25 Nm

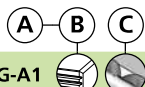

**PAND125-34PRG-A1**

- 1 1x TB180899
- X = 125
- kg ~1,2

**PAND150-34PRG-A1**

- 1 1x TB160145
- 3 1x PCSP50R
- 4 1x PCSP50L
- 5 1x PCS14
- 6 1x PCGU2049
- 7 1x M6X8ISO7380
- 12 4x M5X10ISO4762
- X = 150
- kg ~1,2

X = 150

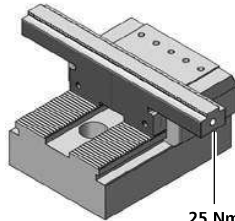

25 Nm

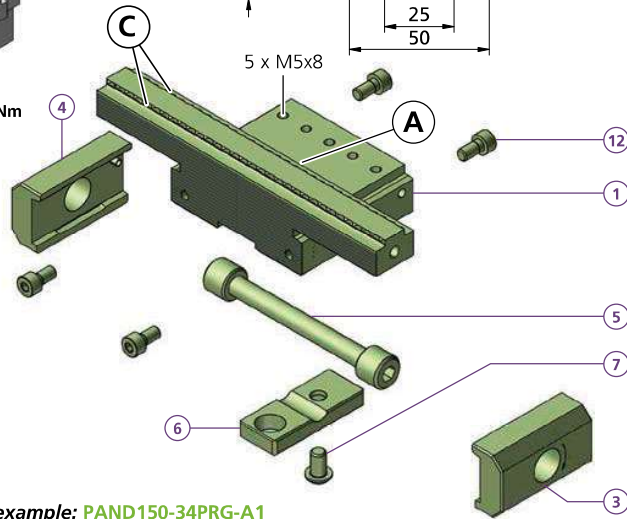
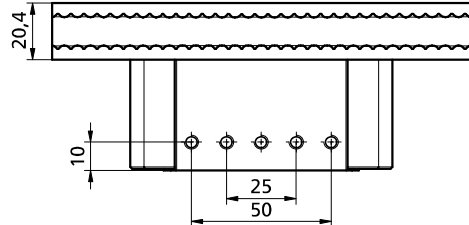
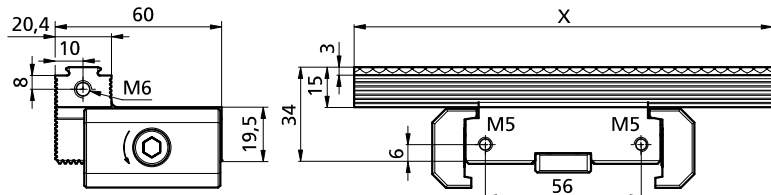

Bestellbeispiel / Ordering example: **PAND150-34PRG-A1**

H = 34

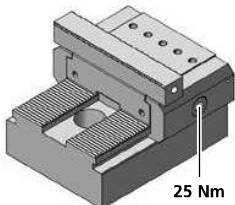

25 Nm



**PAND94-34PRGV**

- 1 1x TH171180
- 3 1x PCSP60R
- 4 1x PCSP60L
- 5 1x PCS14
- 6 1x PCGU2059
- 7 1x M6X8ISO7380
- 12 4x M5X10ISO4762
- H = 34
- H1 = 15
- A = 17,5
- kg ~1,2

**PAND94-49PRGV**

- 1 1x TH171179
- H = 49
- H1 = 30
- A = 17
- kg ~1,6

H = 49

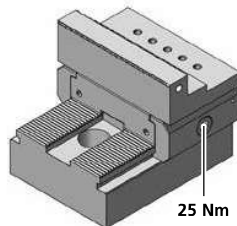

25 Nm

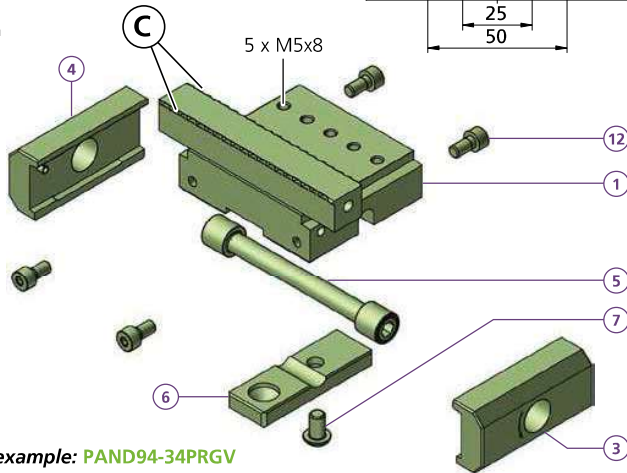
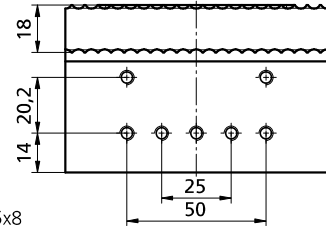
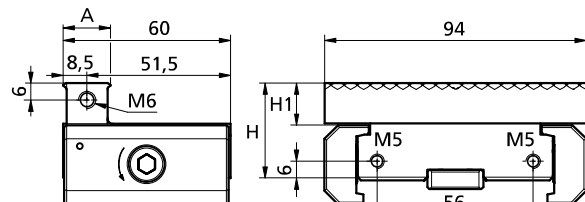

Bestellbeispiel / Ordering example: **PAND94-34PRGV**

# Anschlagmodule zum prägen End modules for stamping

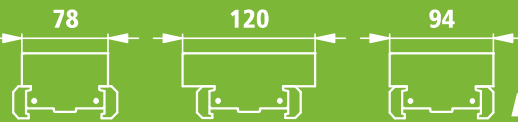

powerCLAMP

Art. Nr.	kg	Z	H
<b>PAND78-34UPRG</b>	~1,2	60	34
<b>PAND78-49UPRG</b>	~1,5	60	49
<b>PAND78-34X50UPRG</b>	~0,98	50	34

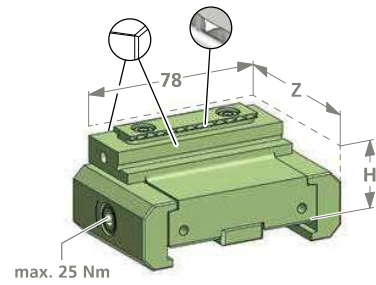

Art. Nr.	kg
<b>PAND120-49UPRG</b>	~1,7

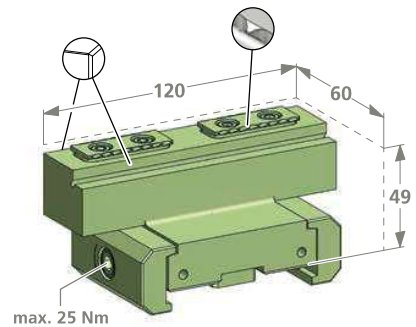

Art. Nr.	kg
<b>PANF94-34PRGM8</b>	~1,47

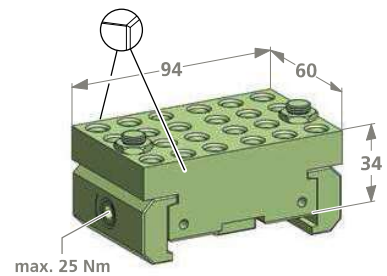

Module einsetzbar auf Zentrischspanner oder Basisschiene.  
Modules can be used on self centrig vise ore base rail.

Der Einsatz dieser Spannwerkzeuge erweitert die Spannmöglichkeiten für runde und unförmige Werkstücke erheblich.

The use of these clamping tools expands the clamping possibilities for round and bulky workpieces considerably.

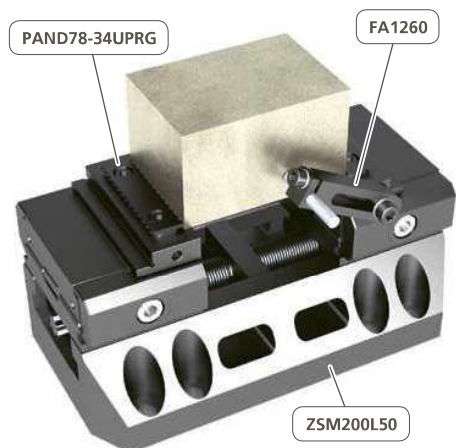
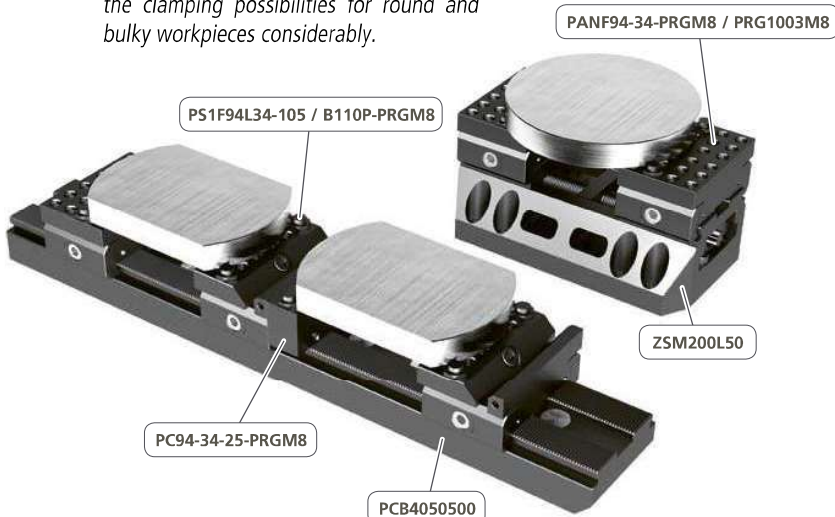

Bei knapp gespannten Werkstücken sind direkt-Prägebacken die ideale Wahl zum spannen.

For tight clamped workpieces, direct stamping jaws are the ideal choice for clamping.

# Rohlingsmodule Blank module

PT-F80-30X60  
PT-F80-30X60NS  
PT-F80-30X30NS

PT-F61-25X60  
PT-F61-25X50  
PT-F61-25X30



powerCLAMP

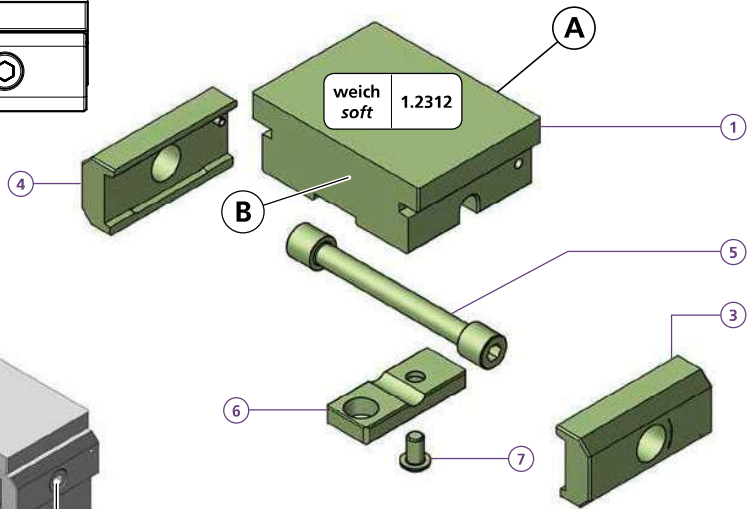
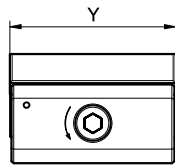
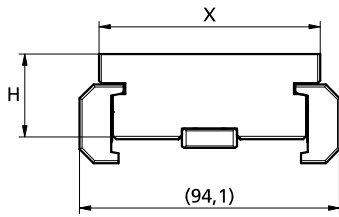

**PT-F80-30X60**

- 1 1x TF140637
- 3 1x PCSP60R
- 4 1x PCSP60L
- 5 1x PCS14
- 6 1x PCGU2049
- 7 1x M6X8ISO7380

X = 80  
H = 30  
Y = 60  
kg ~1,4

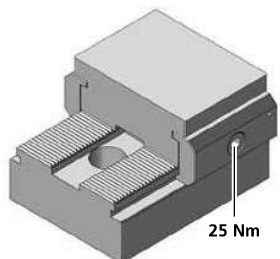

**PT-F61-25X60**

- 1 1x TF140638
- 3 1x PCSP60R
- 4 1x PCSP60L
- 5 1x PCS14
- 6 1x PCGU2049
- 7 1x M6X8ISO7380

X = 61  
H = 25  
Y = 60  
kg ~1,1

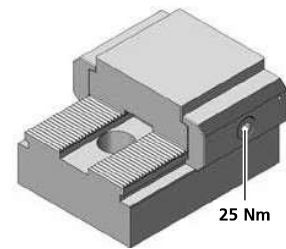

**PT-F80-30X60NS**

NS = Rohlingsmodul freie Positionierung ohne Verzahnung  
Carrier module without positioning serration for free positioning

- 1 1x TF140635
- 3 1x PCSP60R
- 4 1x PCSP60L
- 5 1x PCS14
- 6 1x PCGU2049
- 7 1x M6X8ISO7380

X = 80  
H = 30  
Y = 60  
kg ~1,4

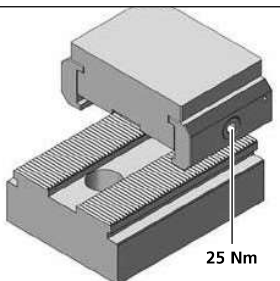

**PT-F61-25X50**

- 1 1x TF140750
- 3 1x PCSP50R
- 4 1x PCSP50L
- 5 1x PCS14
- 6 1x PCGU2049
- 7 1x M6X8ISO7380

X = 61  
H = 25  
Y = 50  
kg ~1,0

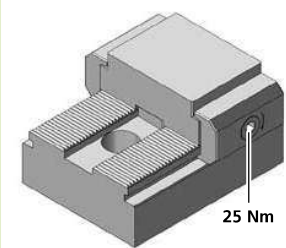

**PT-F80-30X30NS**

NS = Rohlingsmodul freie Positionierung ohne Verzahnung  
Carrier module without positioning serration for free positioning

- 1 1x TF140749
- 3 1x PCSP30R
- 4 1x PCSP30L
- 5 1x PCS14
- 6 1x PCGU2030
- 7 1x M6X8ISO7380

X = 80  
H = 30  
Y = 30  
kg ~0,7

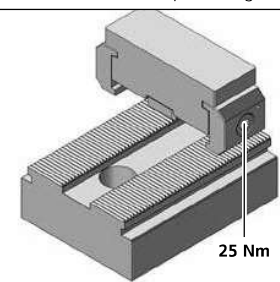

**PT-F61-25X30**

- 1 1x TF140636
- 3 1x PCSP30R
- 4 1x PCSP30L
- 5 1x PCS14
- 6 1x PCGU2049
- 7 1x M6X8ISO7380

X = 61  
H = 25  
Y = 30  
kg ~0,6

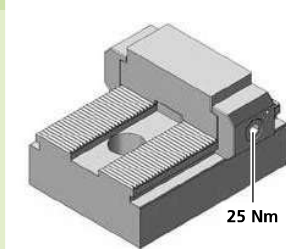

Bestellbeispiel / Ordering example: PT-F80-30X60

# Rohlingsmodule Blank module

**PR94-49SET**  
**PR125-49SETALU**  
**PT-F132-34RDSET**

**PR94-39-50SET**  
**PR150-49SET**  
**PR125-49SET**



**powerCLAMP**

- |                       | A               | B | C |
|-----------------------|-----------------|---|---|
| <b>PR94-49SET</b>     |                 |   |   |
| 1                     | 1x PR94-49      |   |   |
| 3                     | 1x PCSP50R      |   |   |
| 4                     | 1x PCSP50L      |   |   |
| 5                     | 1x PCS14        |   |   |
| 6                     | 1x PCGU2049     |   |   |
| 7                     | 1x M6X8ISO7380  |   |   |
| X                     | = 94            |   |   |
| H                     | = 49            |   |   |
| Y                     | = 60,4          |   |   |
| kg                    | ~2,3            |   |   |
| <b>PR94-39-50SET</b>  |                 |   |   |
| 1                     | 1x PR94-39-50   |   |   |
| X                     | = 94            |   |   |
| H                     | = 39            |   |   |
| Y                     | = 50,4          |   |   |
| kg                    | ~1,6            |   |   |
| <b>PR125-49SET</b>    |                 |   |   |
| 1                     | 1x PR125-49     |   |   |
| X                     | = 125           |   |   |
| H                     | = 49            |   |   |
| Y                     | = 60,4          |   |   |
| kg                    | ~2,7            |   |   |
| <b>PR125-49SETALU</b> |                 |   |   |
| 1                     | 1x *PR125-49ALU |   |   |
| X                     | = 125           |   |   |
| H                     | = 49            |   |   |
| Y                     | = 60,4          |   |   |
| kg                    | ~0,83           |   |   |
| <b>PR150-49SET</b>    |                 |   |   |
| 1                     | 1x PR150-49     |   |   |
| X                     | = 150           |   |   |
| H                     | = 49            |   |   |
| Y                     | = 60,4          |   |   |
| kg                    | ~3,1            |   |   |

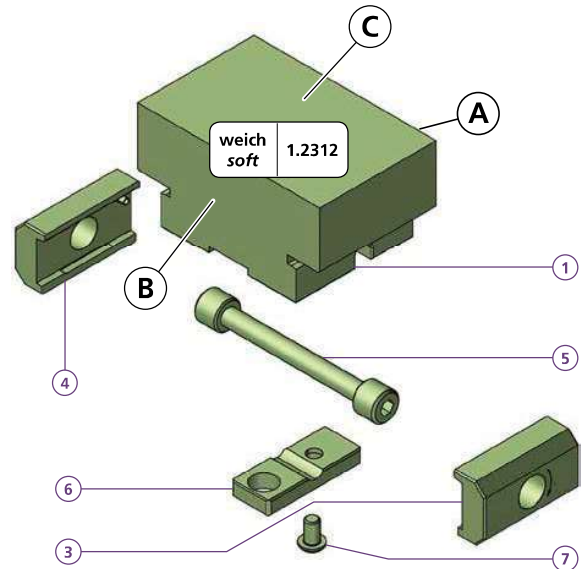
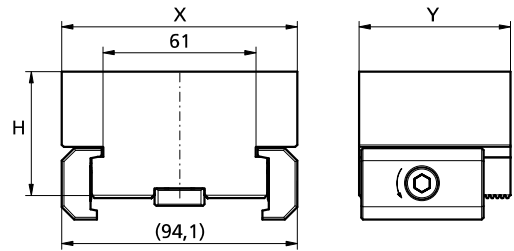
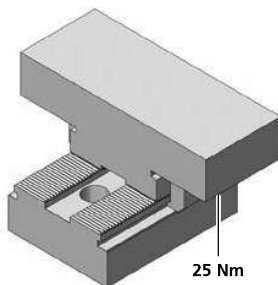
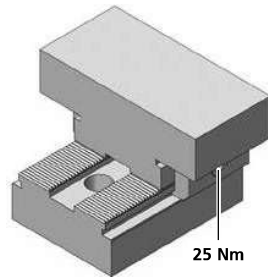
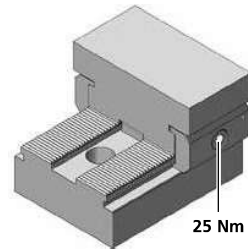
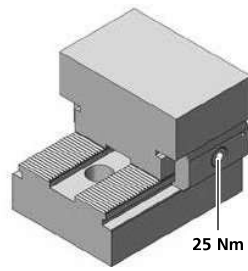

\* ALU = ENAW-7022

Bestellbeispiel / Ordering example: **PR94-49SET**

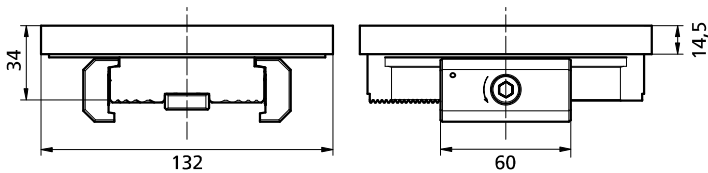

- |                        |                 |
|------------------------|-----------------|
| <b>PT-F132-34RDSET</b> |                 |
| 1                      | 1x PT-F132-34RD |
| 3                      | 1x PCSP60R      |
| 4                      | 1x PCSP60L      |
| 5                      | 1x PCS14        |
| 6                      | 1x PCGU2059     |
| 7                      | 1x M6X8ISO7380  |
| kg                     | ~3,1            |

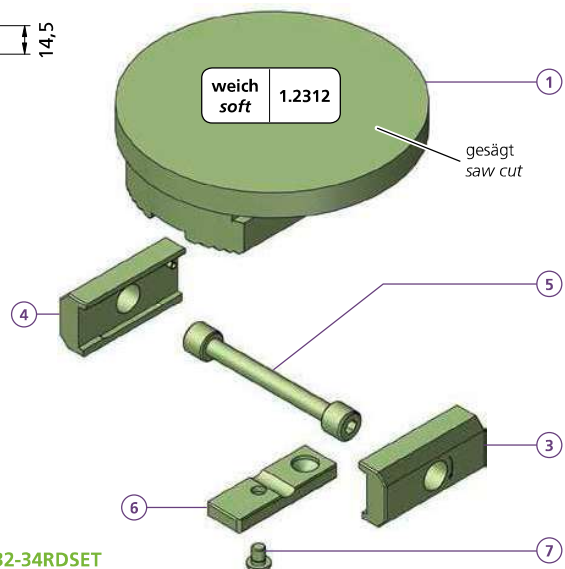
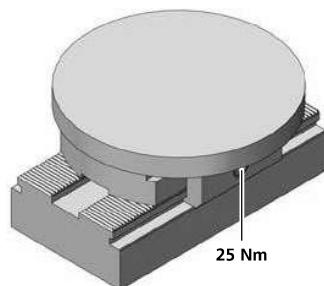

Bestellbeispiel / Ordering example: **PT-F132-34RDSET**

**PTX160-77S**  
**PTX160-57S**



**powerCLAMP**

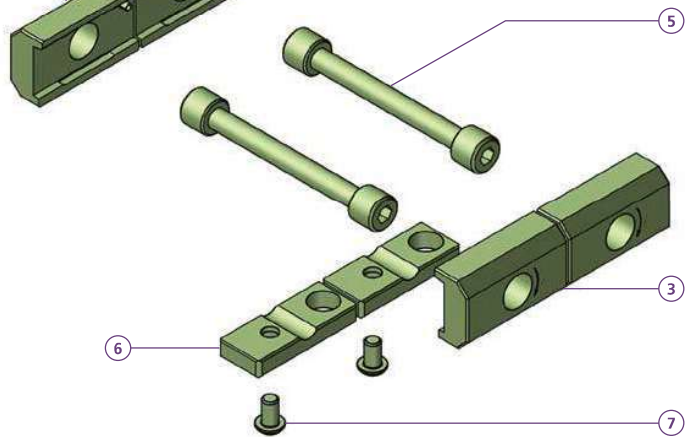
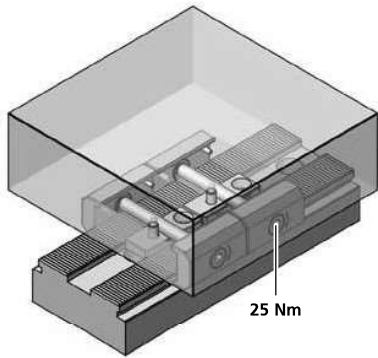
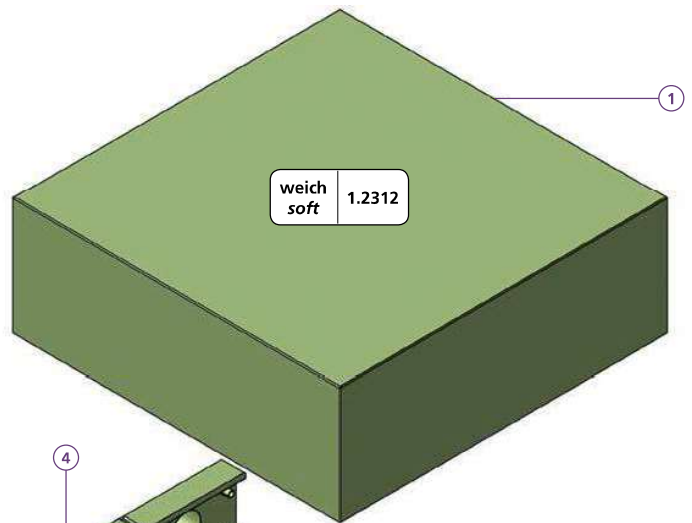
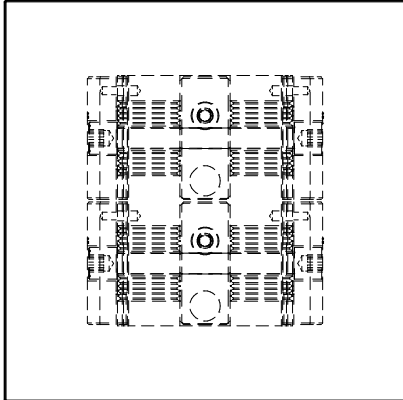
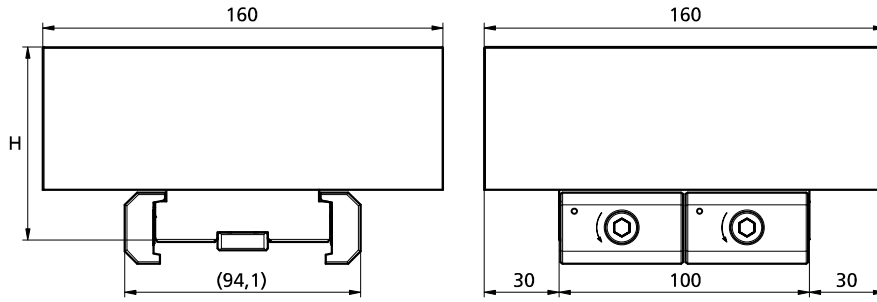

PTX160-57S	
①	1x TH130539
③	2x PCSP50R
④	2x PCSP50L
⑤	2x PCS14
⑥	2x PCGU2049
⑦	2x M6X8ISO7380
H	= 57
kg	~9

PTX160-77S	
①	1x TH130723
H	= 77
kg	~13

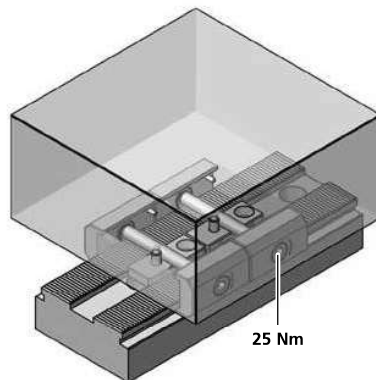

Bestellbeispiel / Ordering example: **PTX160-57S**

# Schnellwechsel - Spannbacken - Rohling

## Quick change - jaw blank



powerCLAMP

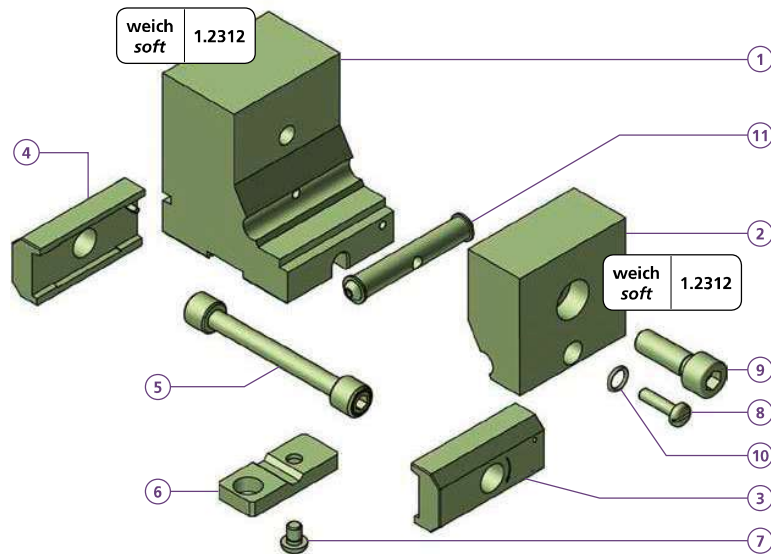
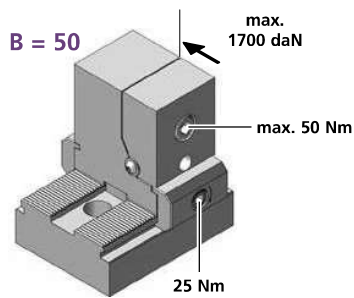
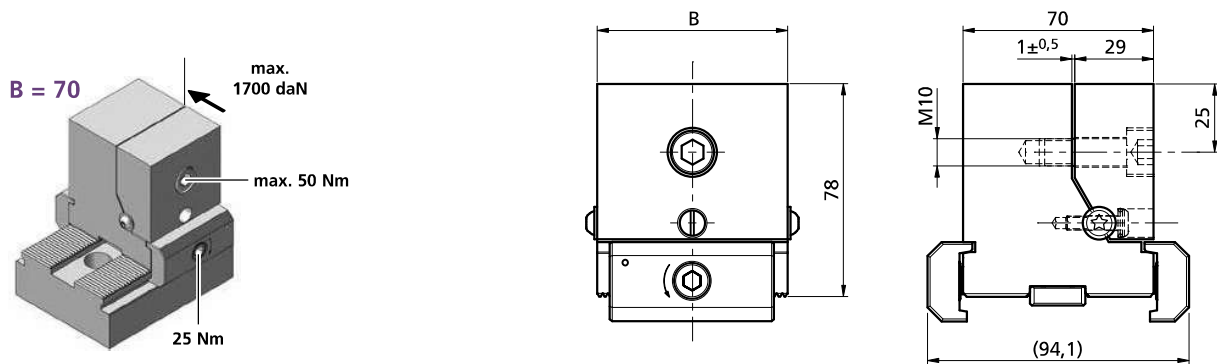

- PS1X70L78ST**
- ① 1x PRS7078AST
  - ② 1x PRS7078SST
  - ③ 1x PCSP60R
  - ④ 1x PCSP60L
  - ⑤ 1x PCS14
  - ⑥ 1x PCGU2049
  - ⑦ 1x M6X8ISO7380
  - ⑧ 1x M5X20BN1362
  - ⑨ 1x M10X30ISO4762
  - ⑩ 1x OR Ø 8x1,5
  - ⑪ 1x PRS7078G
- B = 70  
kg ~3,2

- PS1X50L78ST**
- ① 1x PRS5078AST
  - ② 1x PRS5078SST
  - ③ 1x PCSP50R
  - ④ 1x PCSP50L
  - ⑪ 1x PRS5078G
- B = 50  
kg ~2,3

- PRS70L78ST**
- ① 1x PRS7078AST
  - ② 1x PRS7078SST
  - ⑪ 1x PRS7078G
- B = 70  
kg ~2,8

- PRS50L78ST**
- ① 1x PRS5078AST
  - ② 1x PRS5078SST
  - ⑪ 1x PRS5078G
- B = 50  
kg ~2,0



Drehmoment Torque		Spannkraft Workholding force		
Nm	(lb-ft)	~daN	~(lb)	~t
10	7,4	= 400	880	0,4
20	14,8	= 800	1'760	0,8
30	22,2	= 1'200	2'650	1,2
40	29,6	= 1'600	3'530	1,6

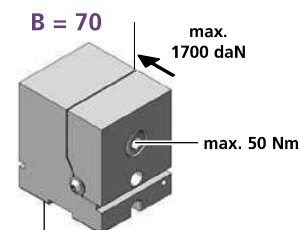

PRS = Rohlingsmodul ohne Spannpratzen  
Blank module side clamp



Spannbacken Rohling auf Kundenwunsch angepasst  
Jaw blank machined to customer specification

Bestellbeispiel / Ordering example: **PS1X70L78ST**



# Dreibackenfutter Three jaw chuck

PS3X80L75BSET  
PS3X100L82BSET  
PS3X125L87BSET



powerCLAMP

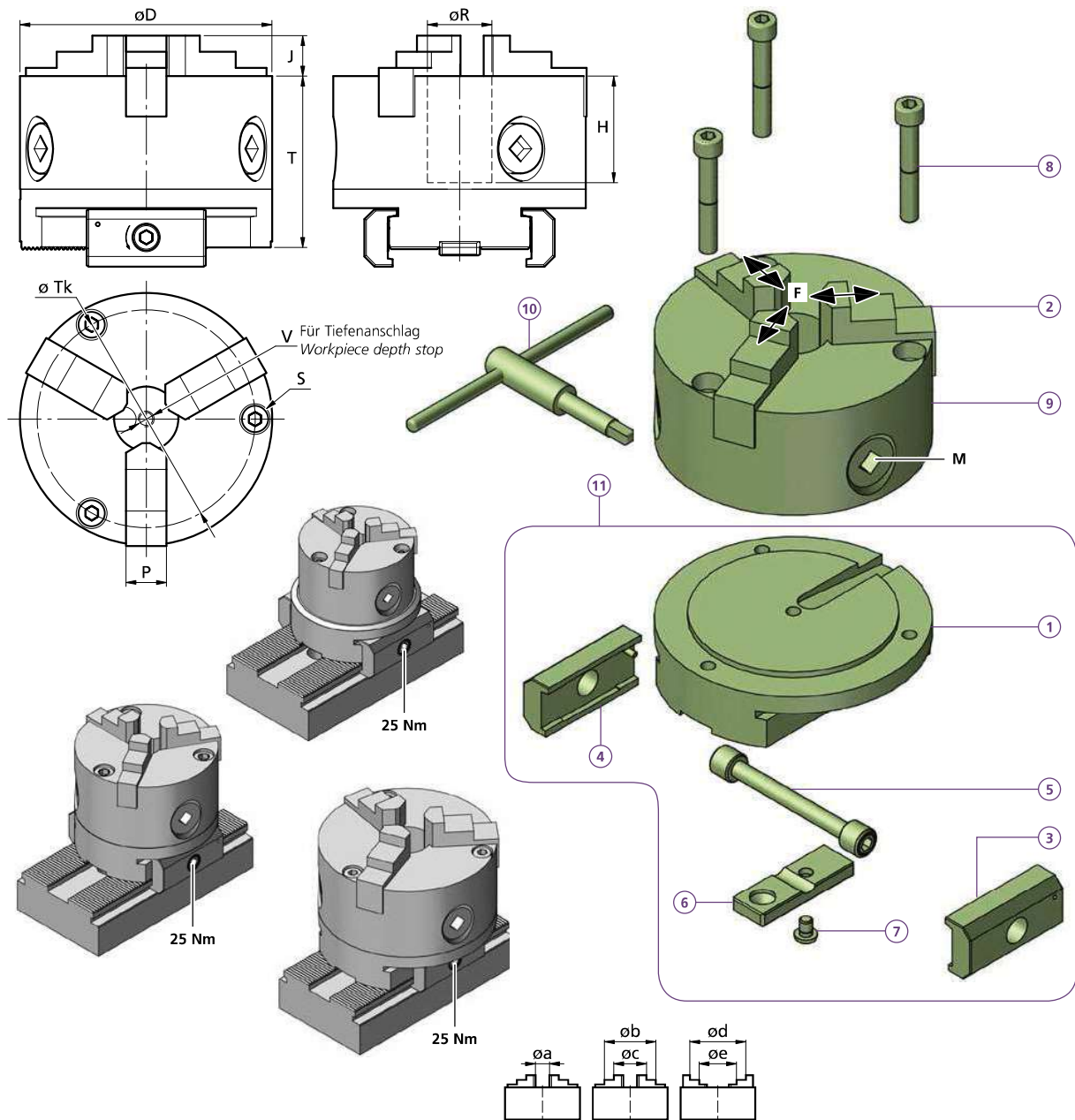

	D	J	T	R	H	P	V	a mm	b mm	c mm	d mm	e mm	M (max.)	F (max.)	$\varnothing T_k$	S
PS3X80L75BSET	80	13	75	15	42,5	10	M6	3...27	48...73	23...48	52...76	27...51	28 Nm	1300 daN	67	M6
PS3X100L82BSET	100	17	82	20	49,5	14	M8	3...39	58...94	24...60	64...100	30...66	38 Nm	1600 daN	83	M8
PS3X125L87BSET	125	19	87	32	55	16	M8	3...49	70...116	30...75	83...125	38...84	55 Nm	2600 daN	108	M8

- PS3X80L75BSET**
- 1 1x TW090013\_01
  - 2 2x 3 Stk. / pcs
  - 3 1x PCSP60R
  - 4 1x PCSP60L
  - 5 1x PCS14
  - 6 1x PCGU2059
  - 7 1x M6X8ISO7380
  - 8 3x M6X45ISO4762
  - 9 1x 243809.0083220
  - 10 1x 243864.0080000
  - 11 PTX80-30
- kg ~2,8

- PS3X100L82BSET**
- 1 1x TW090012\_01
  - 2 2x 3 Stk. / pcs
  - 8 3x M8X50ISO4762
  - 9 1x 243809.0103220
  - 10 1x 243864.0100000
  - 11 PTX100-30
- kg ~4,3

- PS3X125L87BSET**
- 1 1x TW080027\_01
  - 2 2x 3 Stk. / pcs
  - 8 3x M8X55ISO4762
  - 9 1x 243809.0123220
  - 10 1x 243864.0120000
  - 11 PTX125-29
- kg ~6,3

Bestellbeispiel / Ordering example: PS3X125L87BSET

<ul style="list-style-type: none"> <li>243849.0083200</li> <li>243849.0103200</li> <li>243849.0123200</li> </ul>	<ul style="list-style-type: none"> <li>243850.0083200</li> <li>243850.0103200</li> <li>243850.0123200</li> </ul>	<ul style="list-style-type: none"> <li>*243834.0083300</li> <li>*243834.0103300</li> <li>*243834.0123300</li> </ul>
--	--	---

3x  $\varnothing$  3 - 49    3x  $\varnothing$  38 - 125    3x \*Weich Soft 16MnCr5

Separat bestellen / Separate order

**PS1X50N62-ER32**     $\varnothing$  1 - 22 mm  
**PS1X50N100-ER32**     $\varnothing$  1 - 22 mm  
**PS1X63N100-ER40**     $\varnothing$  2 - 30 mm



**powerCLAMP**

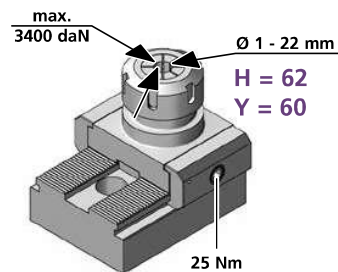
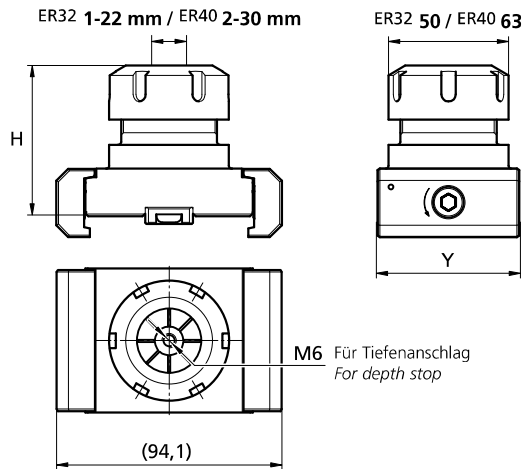

PS1X50N62-ER32	
1	1x TW090089-01
2	1x ER32
3	1x PCSP60R
4	1x PCSP60L
5	1x PCS14
6	1x PCGU2059
7	1x M6X8ISO7380
8	1x ER/ESX32
H = 62	
Y = 60	
kg ~1,3	

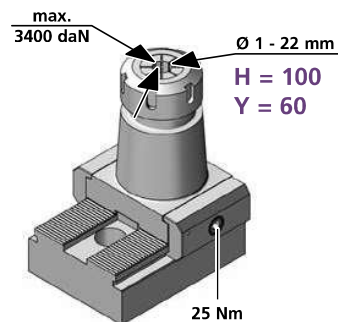

PS1X50N100-ER32	
1	1x TW090047-01
H = 100	
Y = 60	
kg ~2,2	

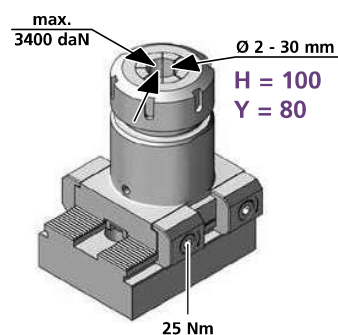

PS1X63N100-ER40	
1	1x TW110026-01
2	1x ER40
3	2x PCSP30R
4	2x PCSP30L
5	2x PCS14
6	2x PCGU2020
7	2x M6X8ISO7380
8	1x ER/ESX40
9	1x M33x2 DIN908
H = 100	
Y = 80	
kg ~2,3	

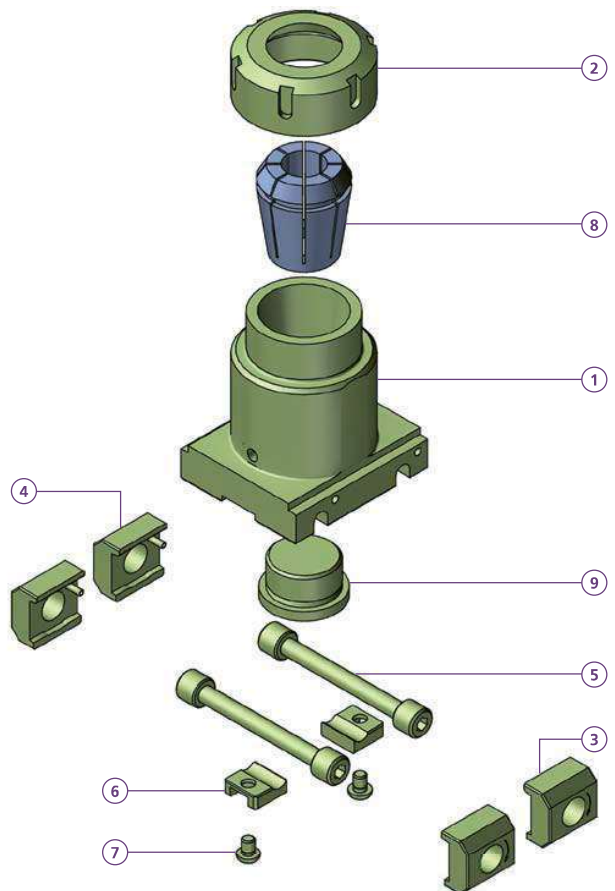
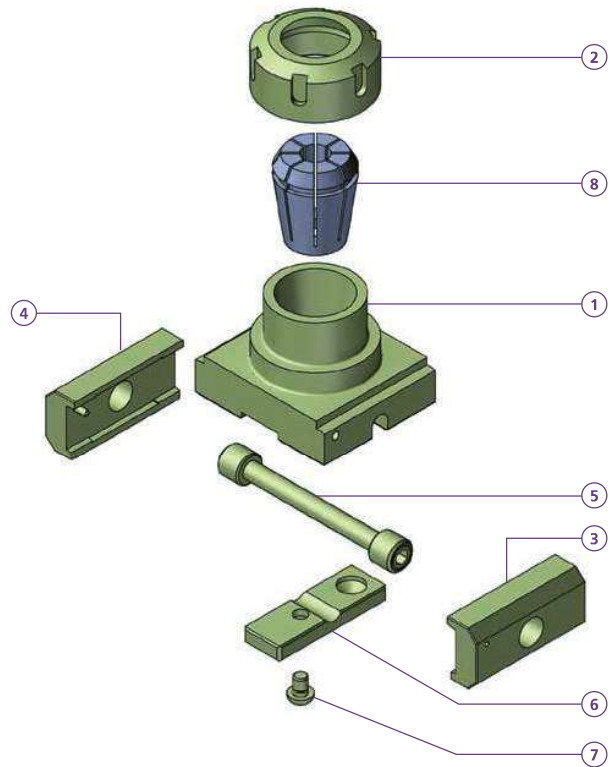

Bestellbeispiel / Ordering example: 1x PS1X 50N62 -ER32 & 1x ER32

Separat bestellen / Separate order

# Spannzangenaufnahme Collet receiver



PS1X68N80-W20

powerCLAMP

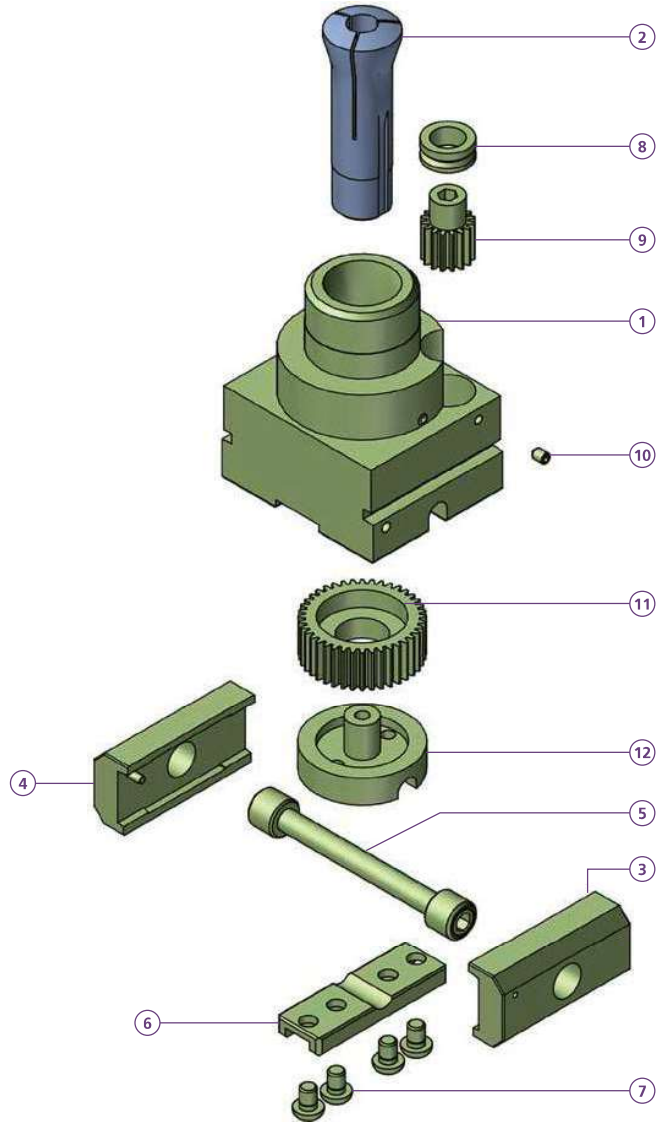
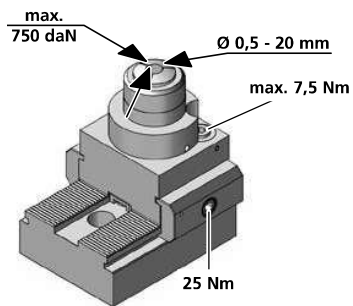
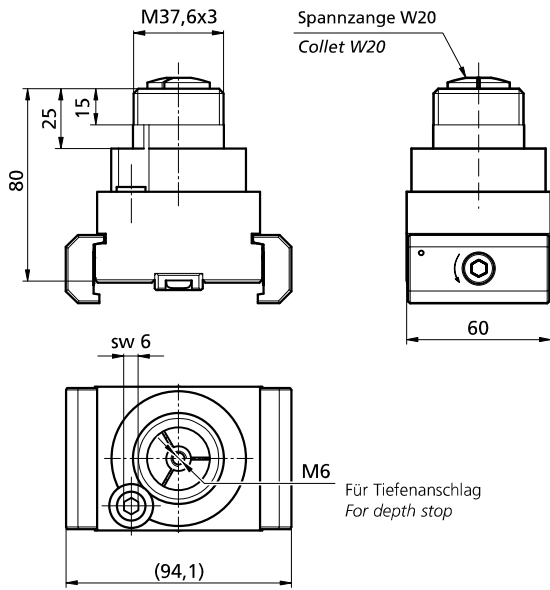

PS1X68N80-W20	
1	1x TW080018-01
2	1x W20
3	1x PCSP60R
4	1x PCSP60L
5	1x PCS14
6	1x PCGUW20
7	4x M6X8ISO7380
8	1x PCD1808
9	1x PCRZ1825
10	1x M4X6ISO4027
11	1x PCZM4215
12	1x PCABD4221
kg	~1,8

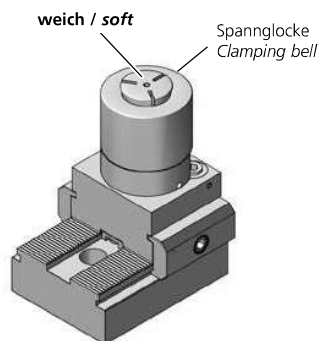

Bestellbeispiel / Ordering example: 1x PS1X68N80-W20 & 1x W20

Separat bestellen / Separate order

PS1F-KLD1  
PS1F-KLD1NS



powerCLAMP

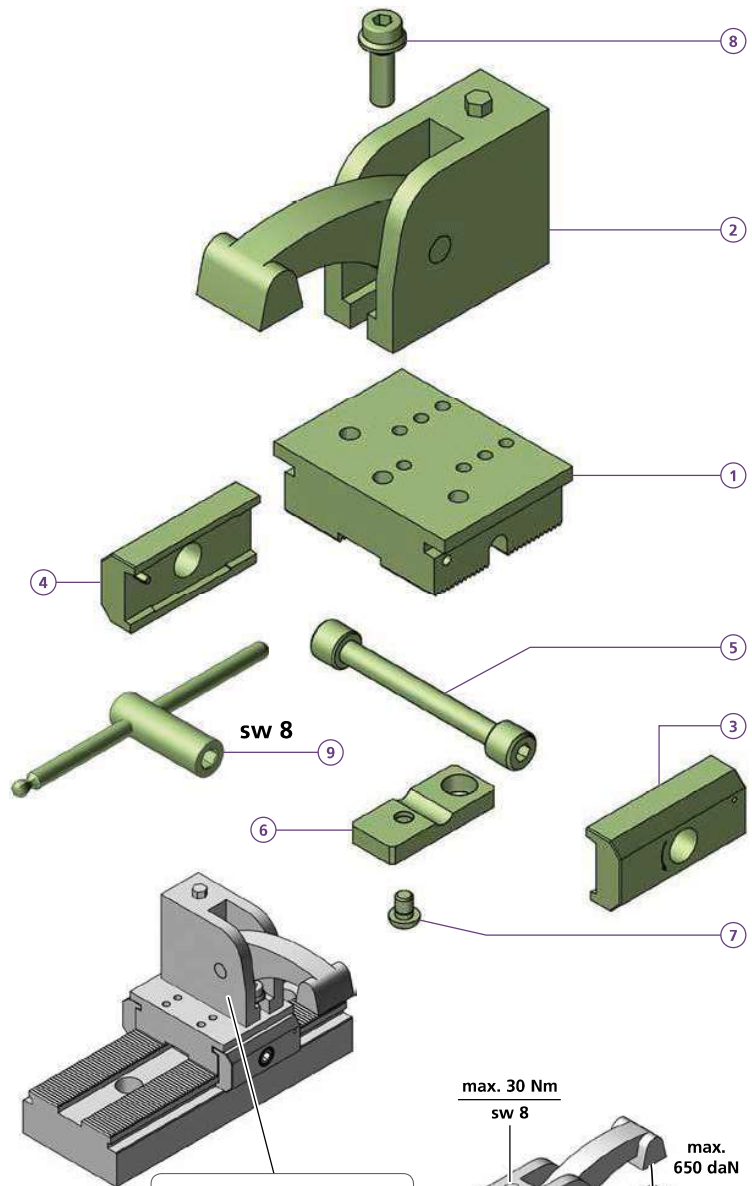
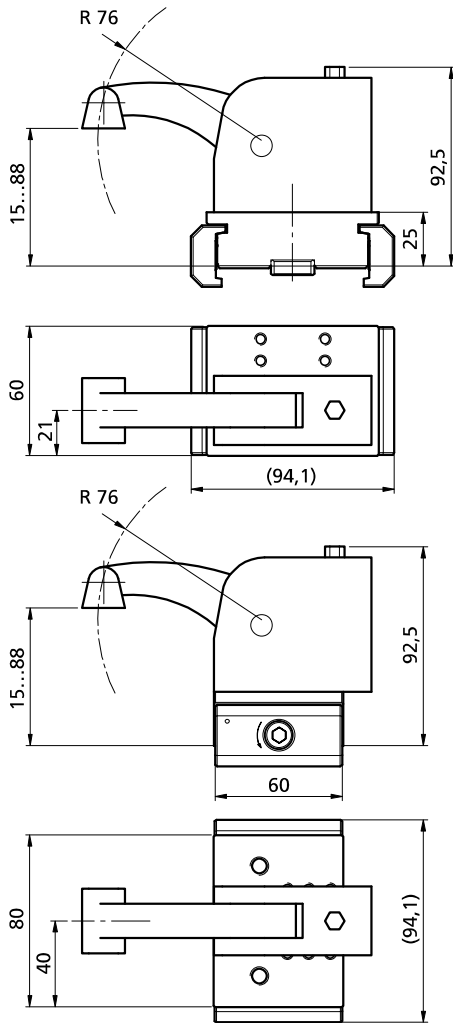

Spanner quer montiert  
Clamp mounted transversely

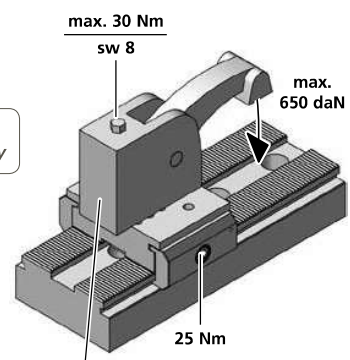

Spanner längs montiert  
Clamp mounted longitudinally

- PS1F-KLD1**
- 1 1x PCTMV1F
  - 2 1x 07-020
  - 3 1x PCSP60R
  - 4 1x PCSP60L
  - 5 1x PCS14
  - 6 1x PCGU2049
  - 7 1x M6X8ISO7380
  - 8 1x M8x25 TW080012-02
  - 9 1x 07-180
- kg ~2,1
- PS1F-KLD1NS**
- 2 1x PCTMV1FNS
- kg ~2,1



NS = Trägermodul freie Positionierung ohne Verzahnung  
Carrier module without positioning serration for free positioning

Bestellbeispiel / Ordering example: PS1F-KLD1NS

**Plattenspanner**  
*Plate clamping modul*

**PS1F20L35BV1**  
**PS1F20L35BV1NS**



**powerCLAMP**

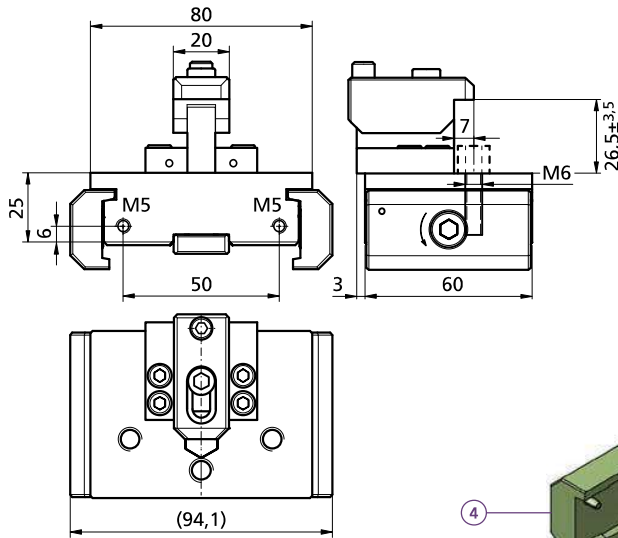

microCLAMP p. 177

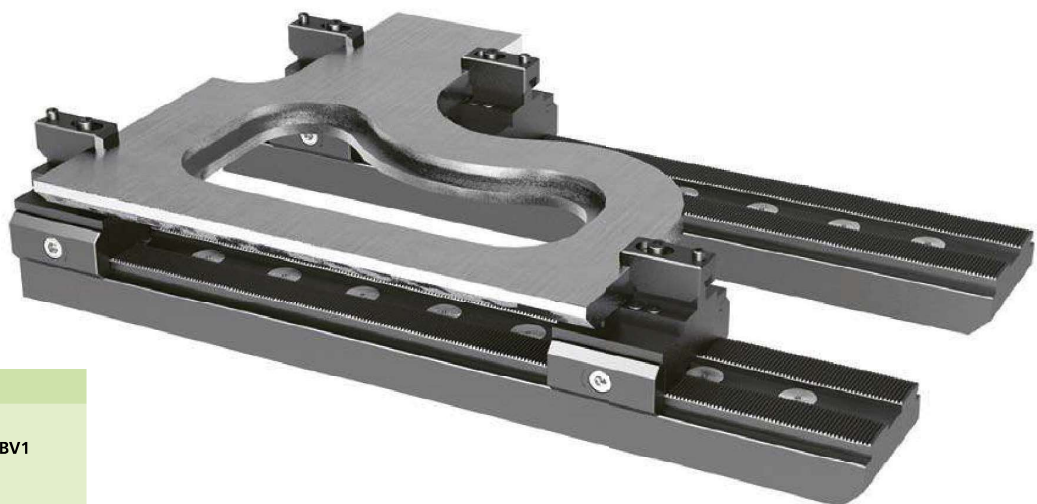
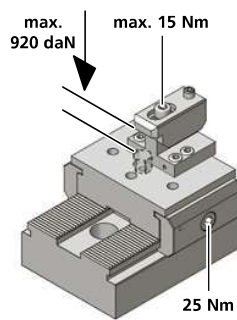
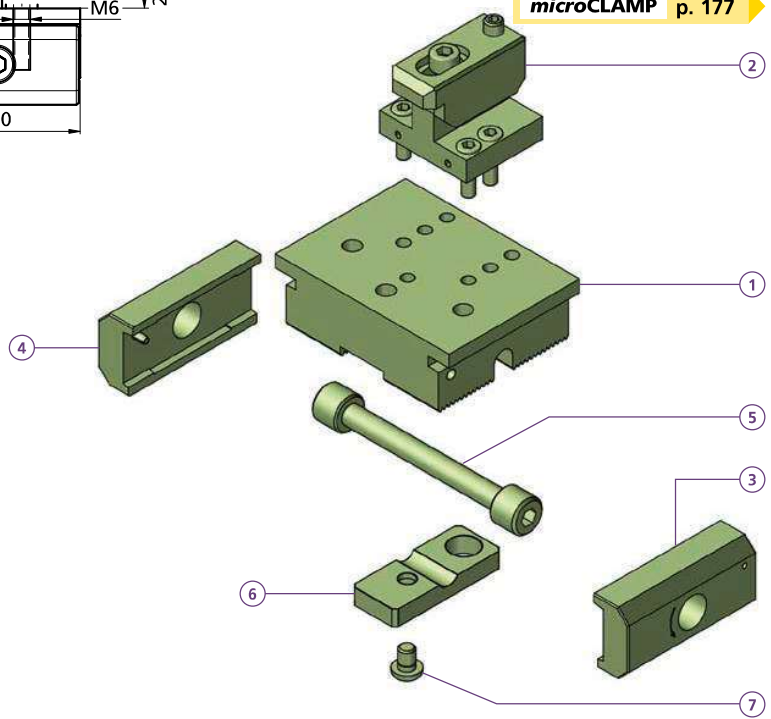

<b>PS1F20L35BV1</b>	
①	1x PCTMV1F
②	1x MV1F20L35BV1
③	1x PCSP60R
④	1x PCSP60L
⑤	1x PCS14
⑥	1x PCGU2049
⑦	1x M6X8ISO7380
kg	~1,4
<b>PS1F20L35BV1NS</b>	
②	1x MV1F20L35BV1
kg	~1,4

**NS** = Trägermodul freie Positionierung ohne Verzahnung  
*Carrier module without positioning serration for free positioning*

Bestellbeispiel / Ordering example: **PS1F20L35BV1**

# Magnetspannplatte Magnetic chuck

PS1X150L60-250MAG11

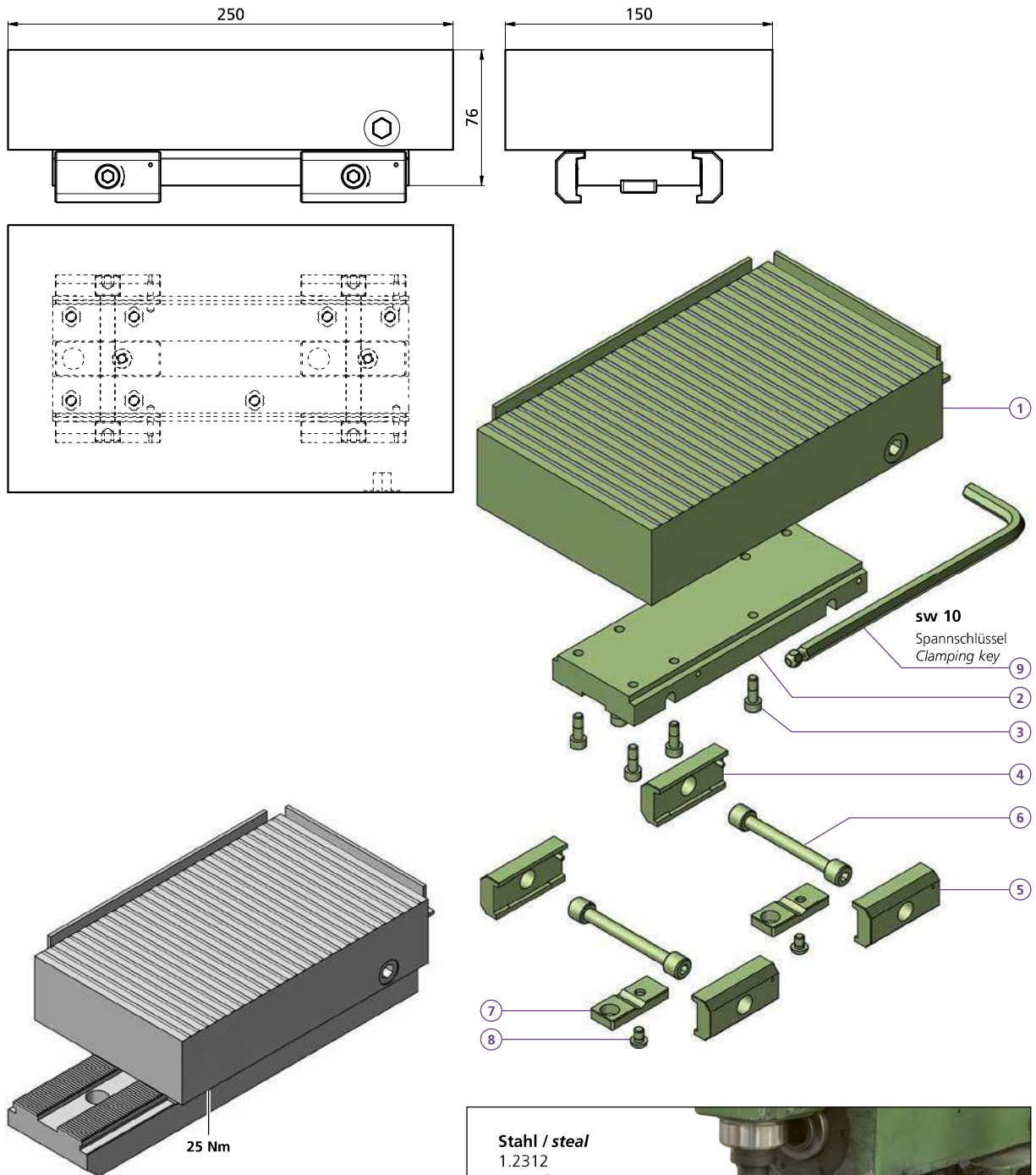

- PS1X150L60-250MAG11**
- ① 1x XNeomill 250x150
  - ② 1x TL110010-01
  - ③ 7x MS60
  - ④ 2x PCSP60L
  - ⑤ 2x PCSP60R
  - ⑥ 2x PCS14
  - ⑦ 2x PCGU2049
  - ⑧ 2x M6X8ISO7380
  - ⑨ 1x ISL10 DIN 911L
- kg ~19,5

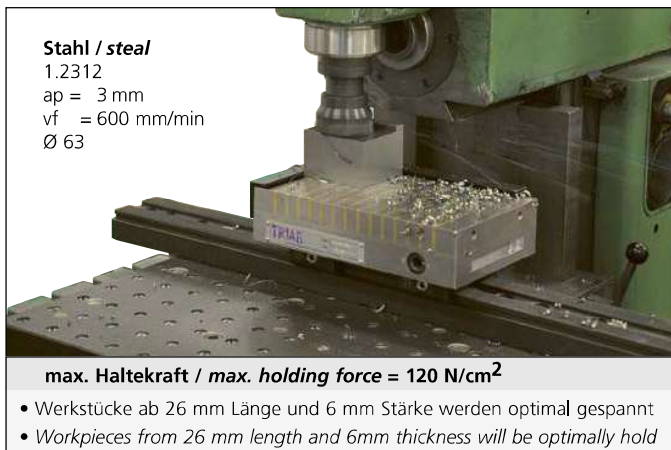

**Stahl / steel**  
1.2312  
ap = 3 mm  
vf = 600 mm/min  
Ø 63

**max. Haltekraft / max. holding force = 120 N/cm<sup>2</sup>**

- Werkstücke ab 26 mm Länge und 6 mm Stärke werden optimal gespannt
- Workpieces from 26 mm length and 6mm thickness will be optimally hold

**Bestellbeispiel / Ordering example: PS1X150L60-250MAG11**

# Vakuu-Modul

Vacuum module

PS1X150L60-VAC



powerCLAMP

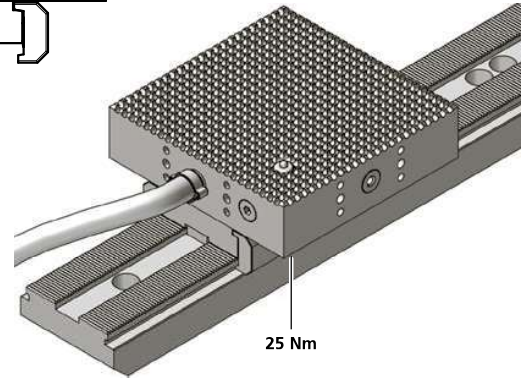
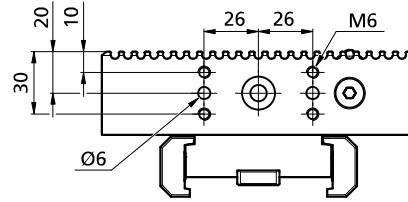
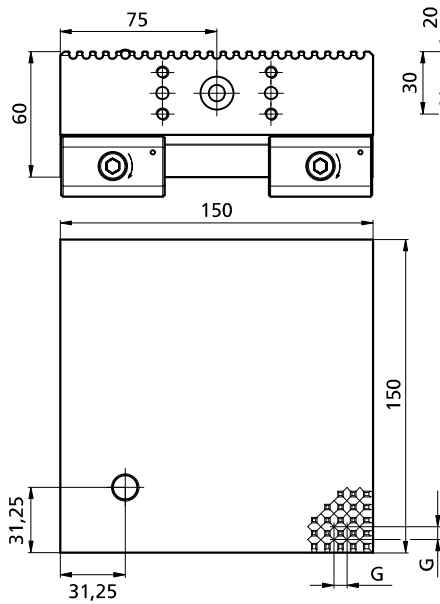

trivaCLAMP p. 318

Mehr Informationen siehe Vacuum  
For more information check the vacuum workholding

Bestellbeispiel / Ordering example: PS1X150L60-VAC

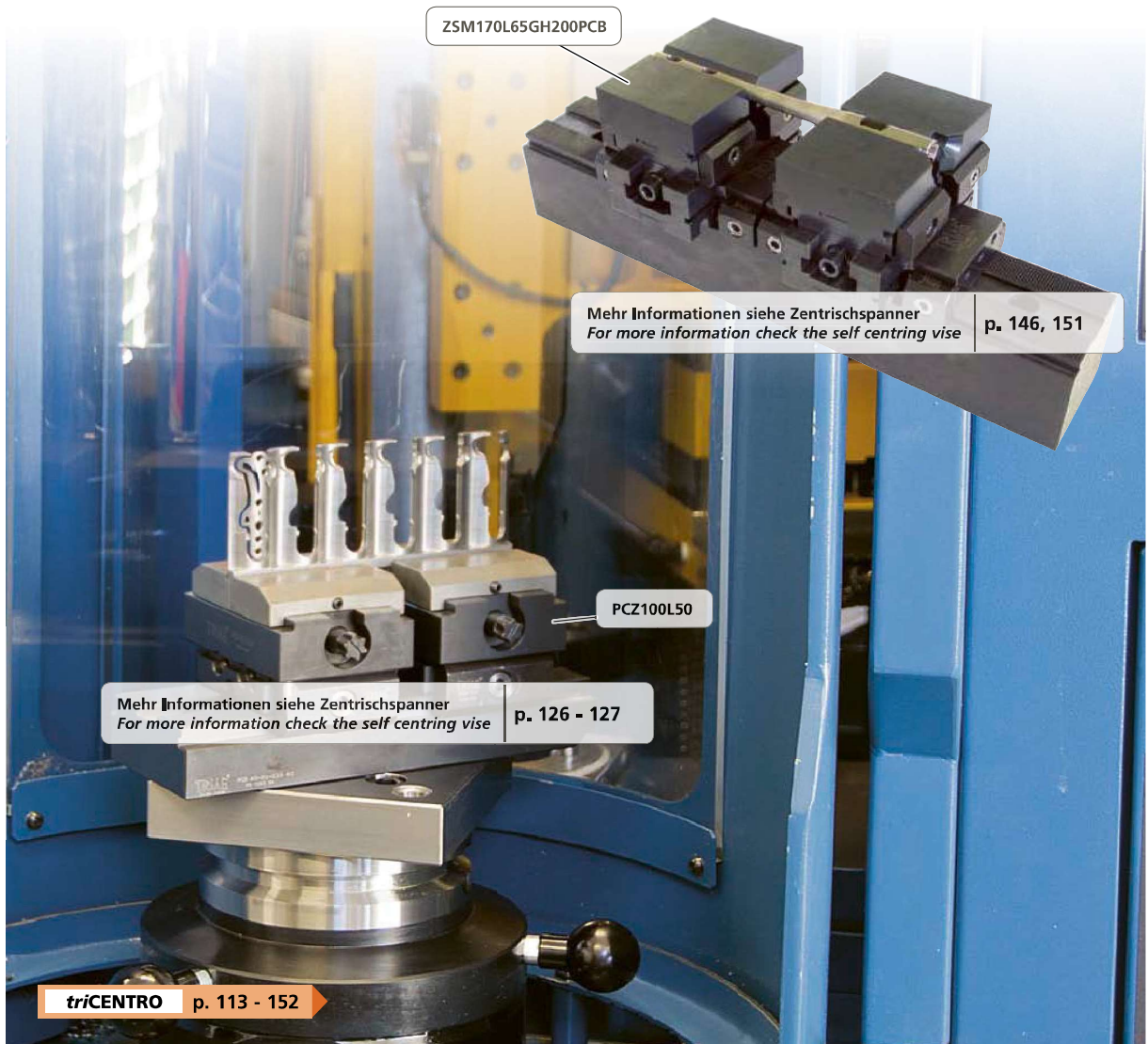

ZSM170L65GH200PCB

Mehr Informationen siehe Zentrischspanner  
For more information check the self centring vise p. 146, 151

PCZ100L50

Mehr Informationen siehe Zentrischspanner  
For more information check the self centring vise p. 126 - 127

triCENTRO p. 113 - 152

Trägermodul zu Erowa Spannfutter  
Support base to Erowa collet chuck

PS1X100-65ER-036345



powerCLAMP

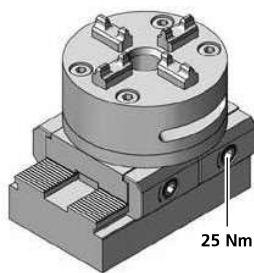
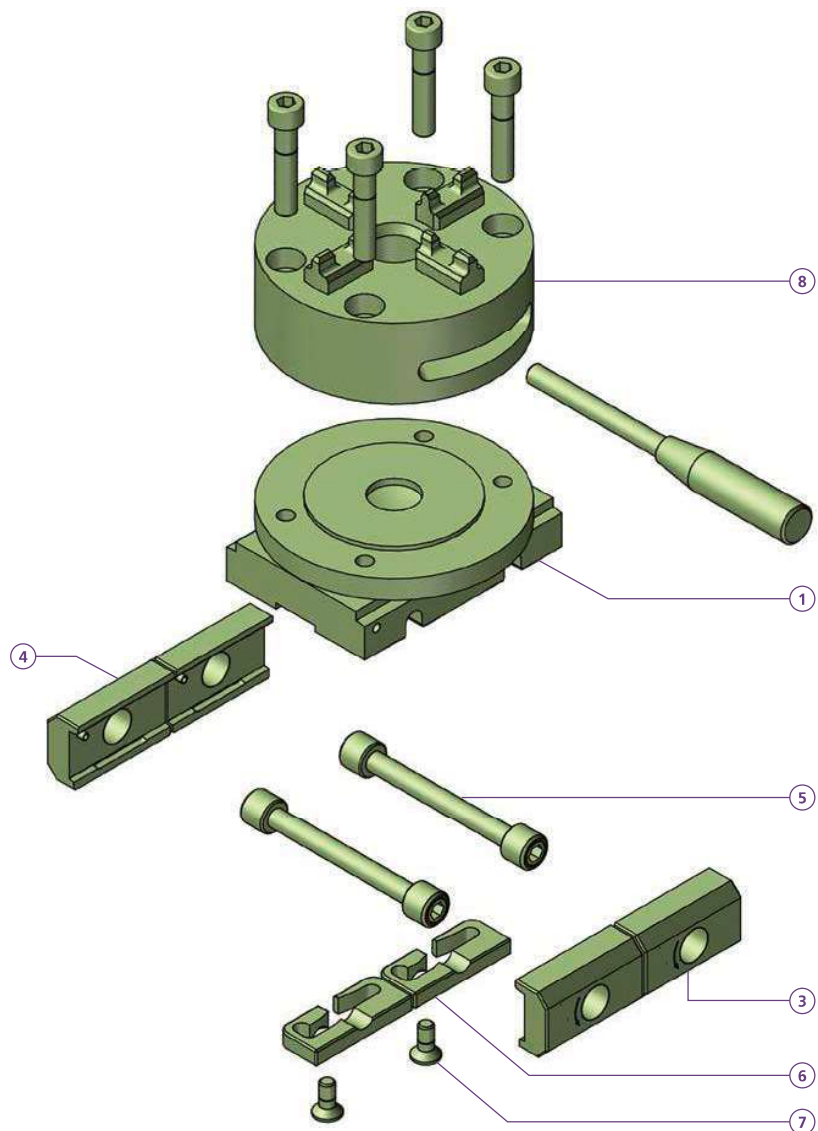
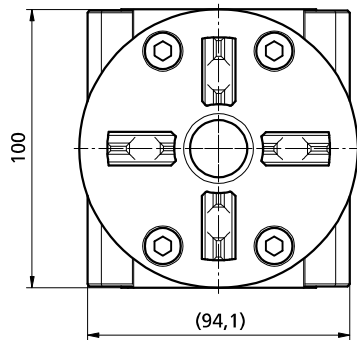
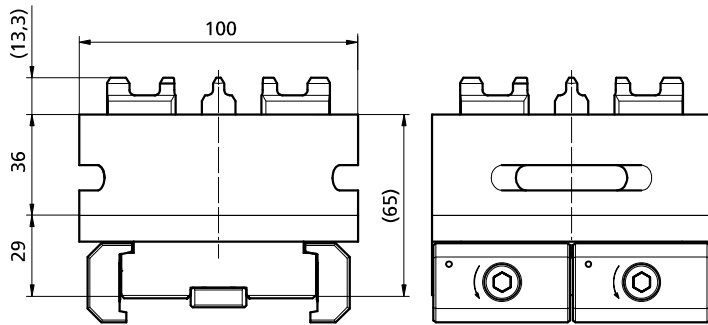

PS1X100-65ER-036345	
1	1x PTX100-29
3	2x PCSP50L
4	2x PCSP50R
5	2x PCS14
6	2x PCGU2049F
7	2x M6X14ISO10642
8	1x ER-036345
kg	~4,0

Bestellbeispiel / Ordering example: PS1X100-65ER-036345



# Hydraulisches Spannmodul Hydraulic clamping module

PSH1X94L49-310



powerCLAMP

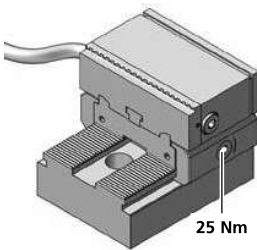
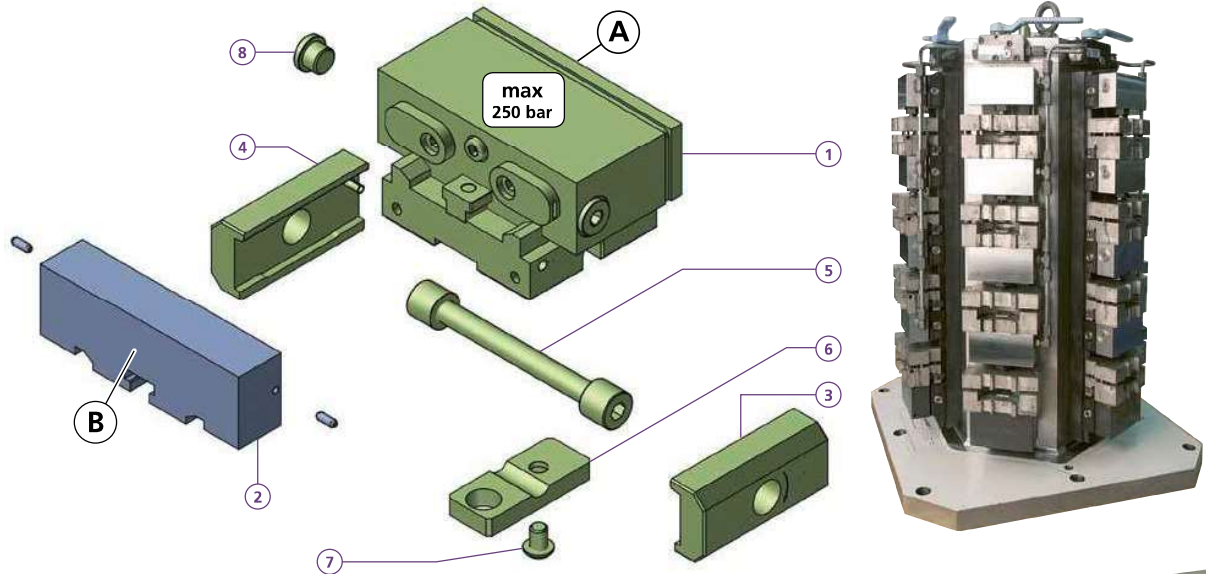
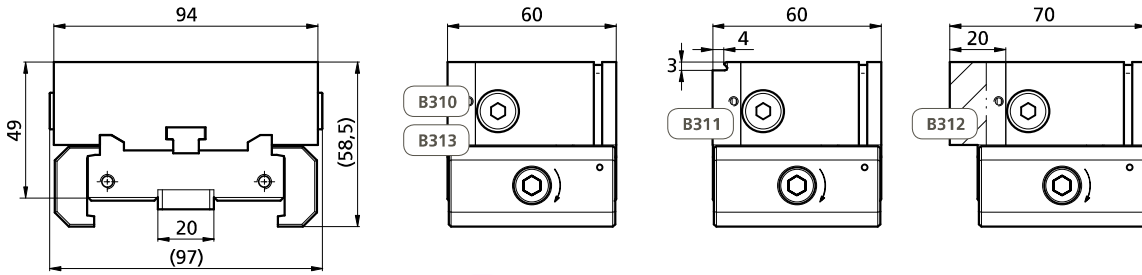

Ölvolumen / Oil volume			
Spannen / Clamping			
8 cm <sup>3</sup>			
5 mm Hub / Stroke			
bar	~daN	~(lb)	~t
100	= 960	2116	0,96
150	= 1'440	3175	1,44
200	= 1'920	4233	1,92
250	= 2'400	5291	2,4



Bestellbeispiel / Ordering example: PSH1X94L49-310 & 1 x B310

	B310	B311	B312	B313
<b>C</b>	94	94	94	94
<b>H</b>	31,5	31,5	31,5	31,5
<b>L</b>	10	10	20	10
<b>i</b>	HV700 x0,2mm	57HRC	*	HV700 x0,2mm
<b>kg</b>	~0,18	~0,17	~0,39	~0,17

PSH1X94L49-310	
1	1x ZF191349
2	1x
3	1x PCSP60R
4	1x PCSP60L
5	1x PCS14
6	1x PCGU2049
7	1x M6X8ISO7380
8	2x TN100014
<b>kg</b>	~1,94

B310

B311

B313

B312

**Zum Erstellen Ihrer individuellen Formbacke:**  
Schnittzeichnung zum Ermitteln der maximalen Bearbeitungsprofiltiefe

**If a dedicated jaw is being machined:**  
Sectional drawing to determine the maximum machining depth

Separat bestellen / Separate order

\* = weich / soft (1.7225 Vergütungsstahl / Tempering steel)

# Vorsatzbacken ... Attachment jaws ...



powerCLAMP

für Hartmetalldruckstücke  
for carbide grippers

Art. Nr.	kg	Y	X
<b>PC4349</b>	~0,21	43	49
<b>PC4834</b>	~0,17	48	34
<b>PC9434</b>	~0,23	94	34
<b>PC12549</b>	~0,46	125	49

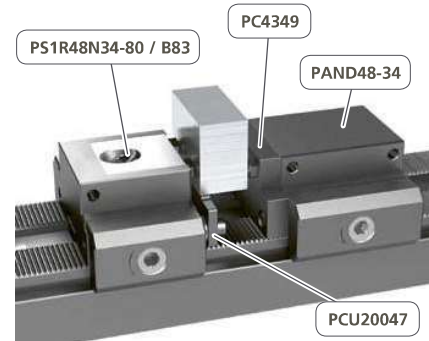
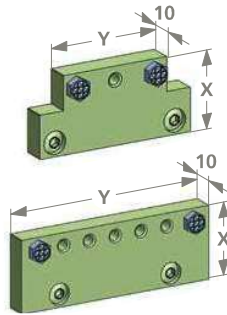

für Hartmetalldruckstücke und Fräsanschlag  
for carbide grippers and milling buffer

Art. Nr.	kg	X
<b>PC4834RF</b>	~0,34	34
<b>PC4849RF</b>	~0,44	49
<b>PC9434RF</b>	~0,43	34
<b>PC9449RF</b>	~0,43	49

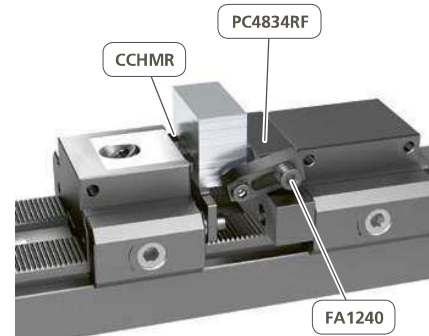
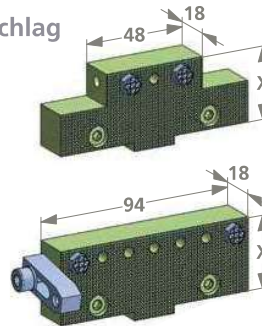

mit pendelnden Kugeldruckstücken  
with swinging ball thrust grippers

Art. Nr.	kg
<b>PC9460</b>	~0,45
<b>PC9460R</b>	~0,45

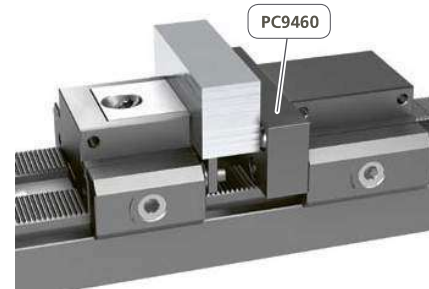
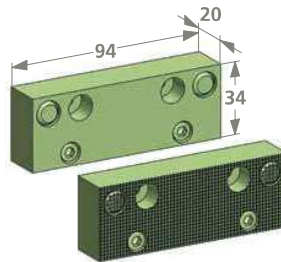

mit Prägeeinsätzen  
with embossed inserts

Art. Nr.	kg
<b>PC9434-25PRGM8</b>	~0,6

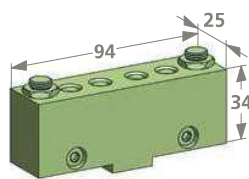

mit direkt-Prägezähnen und Spannstufen  
with direct stamping teeth and clamping steps

Art. Nr.	kg	H
<b>PC48-34PRG</b>	~0,19	34
<b>PC48-49PRG</b>	~0,25	49
<b>PC94-34PRG</b>	~0,36	34
<b>PC94-49PRG</b>	~0,48	49
<b>PC4834-15</b>	~0,19	34
<b>PC4849-15</b>	~0,25	49

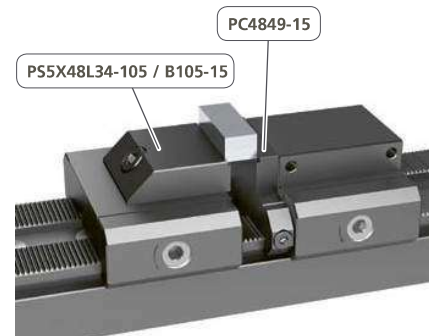
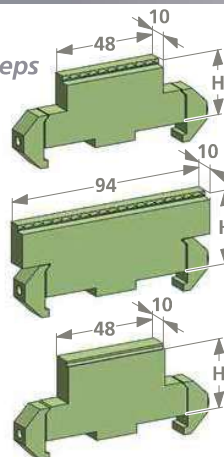

# Vorsatzbacken ... Attachment jaws ...



powerCLAMP

mit Druckstiften  
with pressure pins

Art. Nr.	kg	Y	X
PC4349DS	~0,22	43	49
PC4834DS	~0,17	48	34
PC4849DS	~0,23	48	49
PC9434DS	~0,27	94	34
PC9449DS	~0,38	94	49
PC12549DS	~0,49	125	49



Druckstift  
Pressure pin  
DSE0402-60°  
  
weitere Druckstücke  
more grip-  
ping pins  
p. 337

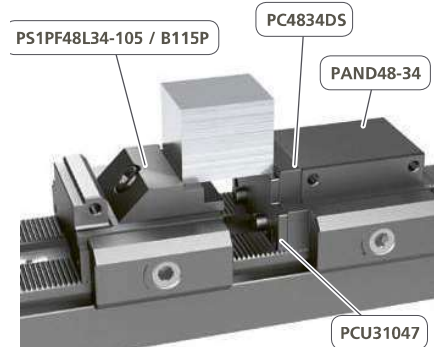
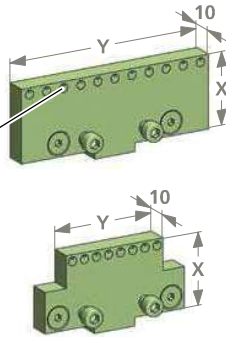

aus weichem Stahl  
from soft steel

Art. Nr.	kg	Z	Y	X
PC943425W	~0,64	94	25	34
PC943430W	~0,77	94	30	34
PC944930W	~1,10	94	30	49
PC1254930W	~1,46	125	30	49

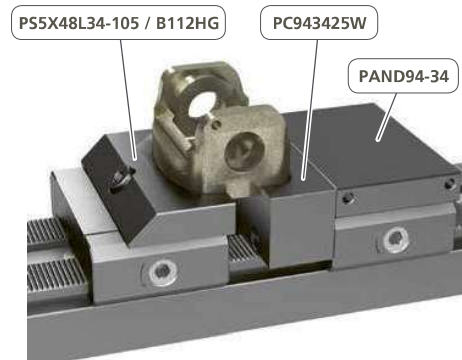
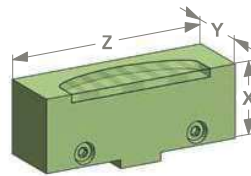

in Prismaform  
in prism form

Art. Nr.	kg	Y	X
PC9434V90-2	~0,58	28	34
PC9449V90-2	~0,84	28	49
PC9434V120	~0,62	35	34
PC9449V120	~0,89	35	49

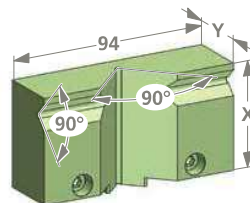
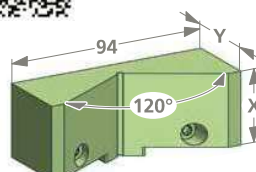

Ø  
min 5  
max 16  
Spanndurch-  
messer hori-  
zontal  
Clamping  
diameter hori-  
zontal

PC9449V90-2

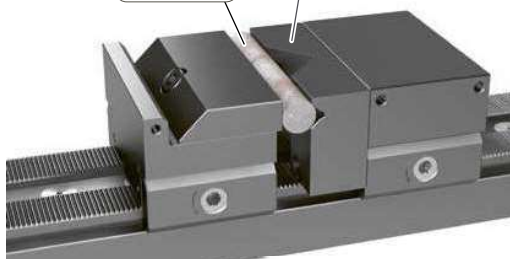

Ø  
min 8  
max 158  
Spanndurch-  
messer verti-  
cal  
Clamping dia-  
meter verti-  
cal

PC9434V120



Ø  
min 16  
max 52  
Spanndurch-  
messer verti-  
cal  
Clamping dia-  
meter verti-  
cal

PAND94-49

PS1F94L49-105 / B110

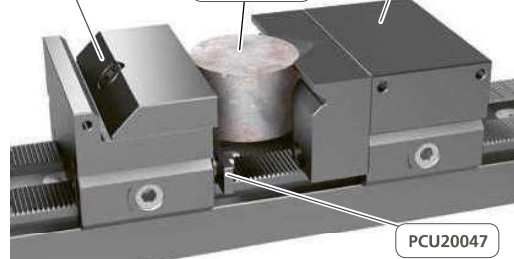

PCU20047



SCAN OR  
CLICK



PDF



STEP



Formbacke  
Moulding jaw



Von Niederzug zu Linear!  
From pull down jaws to linear stroke!

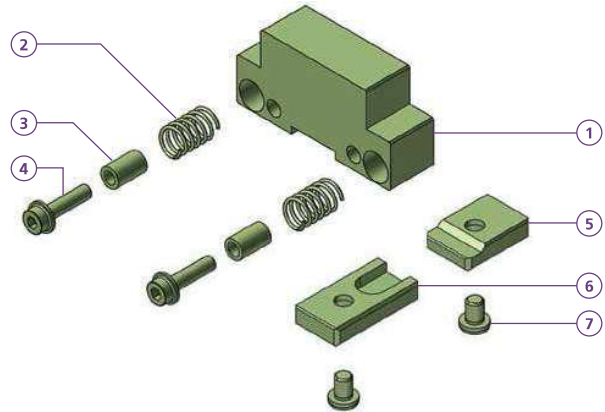
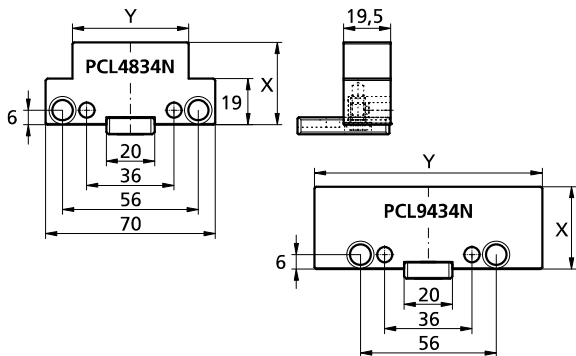

**PCL4349N**

- 1 1x TF140697
- 2 2x FED10175
- 3 2x PCD0813
- 4 2x M5X20BN1392
- 5 1x PCGU2028
- 6 1x PCGU2030LB
- 7 2x M6X8ISO7380

X = 49  
Y = 43  
kg ~-0,43

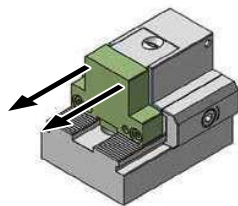

**PCL4834N**

- 1 1x TF140698
- 2 2x FED10175
- 3 2x PCD0813
- 4 2x M5X20BN1392
- 5 1x PCGU2028
- 6 1x PCGU2030LB
- 7 2x M6X8ISO7380
- 8 1x M10X22ISO4762

X = 34  
Y = 48  
kg ~-0,35

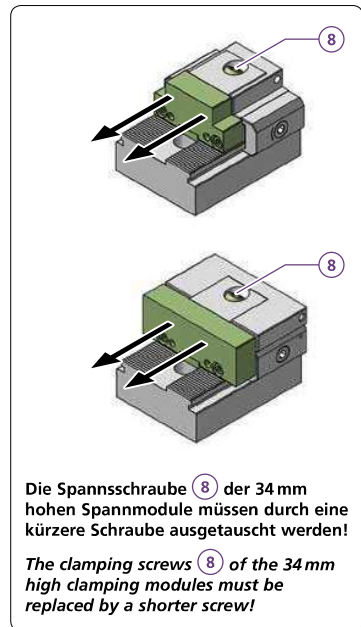

Die Spannschraube 8 der 34 mm hohen Spannmodule müssen durch eine kürzere Schraube ausgetauscht werden!

The clamping screws 8 of the 34 mm high clamping modules must be replaced by a shorter screw!

**PCL9449N**

- 1 1x TF140700

X = 49  
Y = 94  
kg ~-0,74

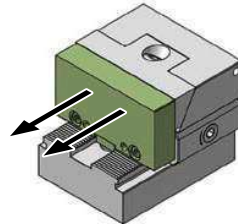

**PCL12549N**

- 1 1x T00317

X = 49  
Y = 125  
kg ~-0,97

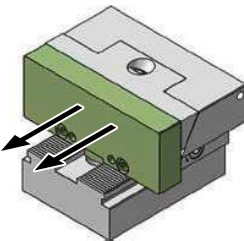

Bestellbeispiel / Ordering example: PCL4834N

Montagehilfe und Ersatzteile für Linearbacken  
Assembling tool for linear jaws and spare parts

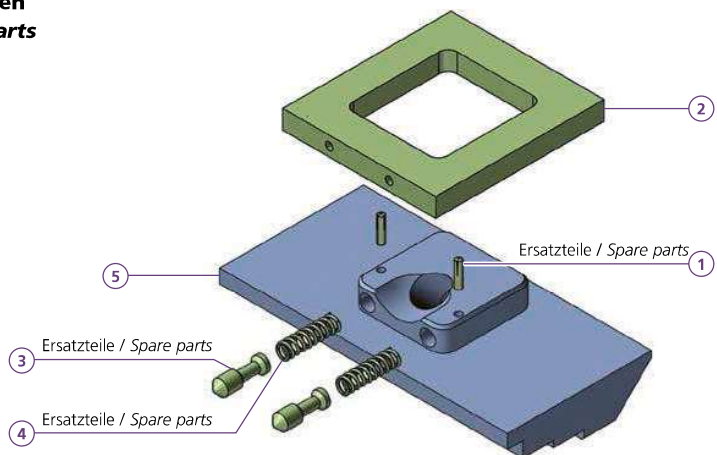
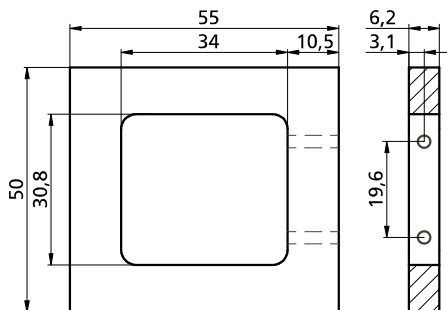

**BL-SET**

- 1 2x TN100823
- 2 1x TK160609
- 3 2x PCRB0516
- 4 2x TN100614
- 5 1x [unlabeled]

kg ~-0,08

p. 84 Alle Linearbacken  
All linear jaws

Montageanleitung siehe Video  
Assembly instructions see video



Separat bestellen / Separate order

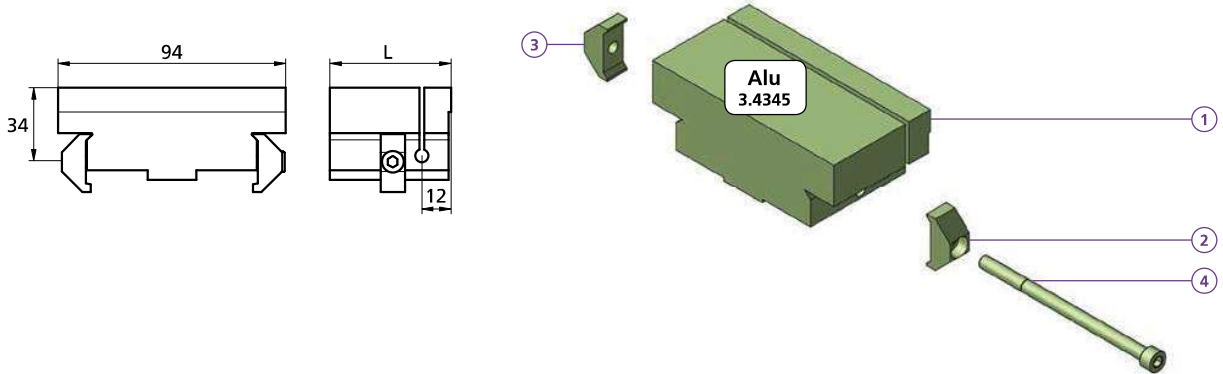

- |               |                 |
|---------------|-----------------|
| <b>PCFX30</b> |                 |
| 1             | 1x TF140702     |
| 2             | 1x PCSP10B      |
| 3             | 1x PCSP10G      |
| 4             | 1x M5X85ISO4762 |
| L             | = 30            |
| kg            | ~0,27           |
| <b>PCFX35</b> |                 |
| 1             | 1x TF140703     |
| L             | = 35            |
| kg            | ~0,31           |

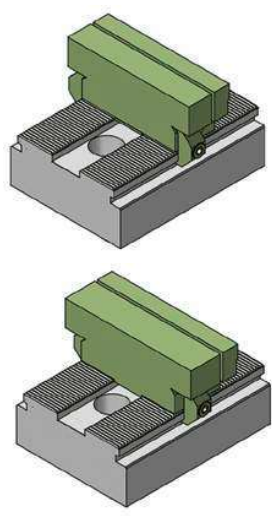

- |               |                 |
|---------------|-----------------|
| <b>PCFX50</b> |                 |
| 1             | 1x TF140704     |
| 2             | 1x PCSP10B      |
| 3             | 1x PCSP10G      |
| 4             | 1x M5X85ISO4762 |
| L             | = 50            |
| kg            | ~0,45           |
| <b>PCFX70</b> |                 |
| 1             | 1x TF140705     |
| L             | = 70            |
| kg            | ~0,62           |

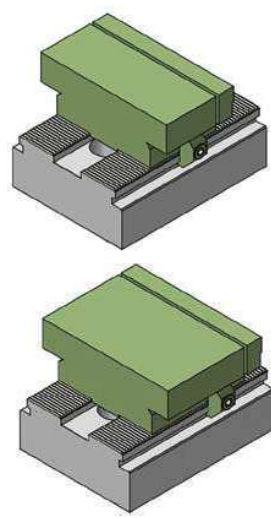

Auf Anfrage in Stahl erhältlich  
On request also in steel

Bestellbeispiel / Ordering example: PCFX30

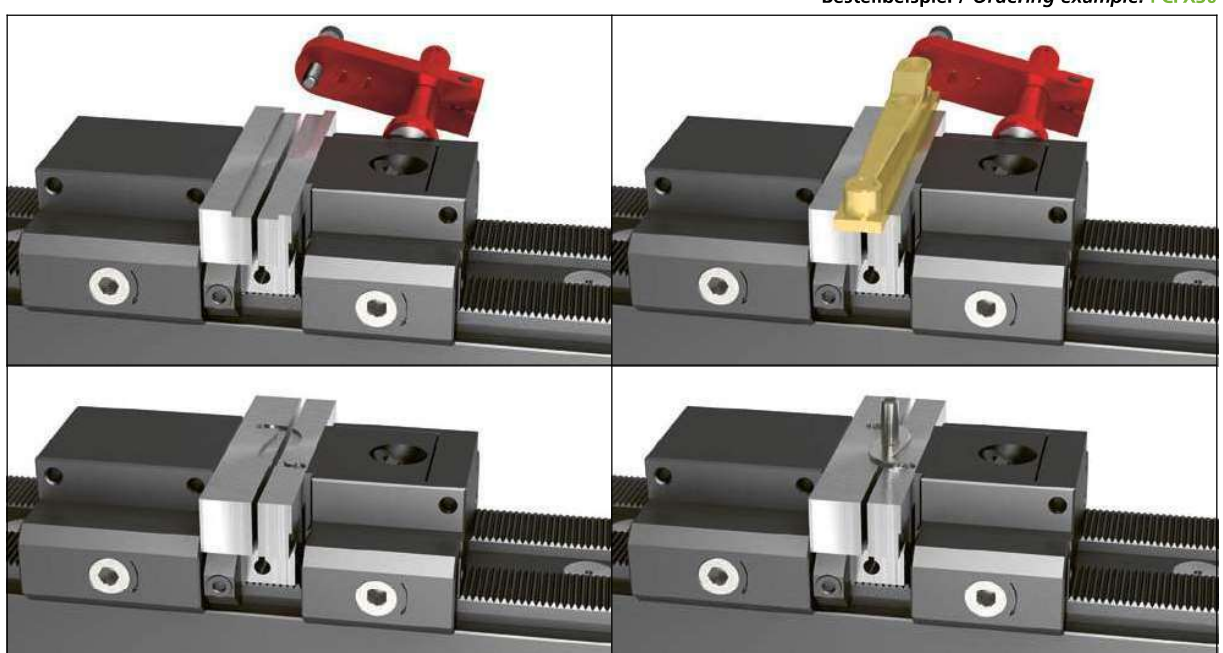

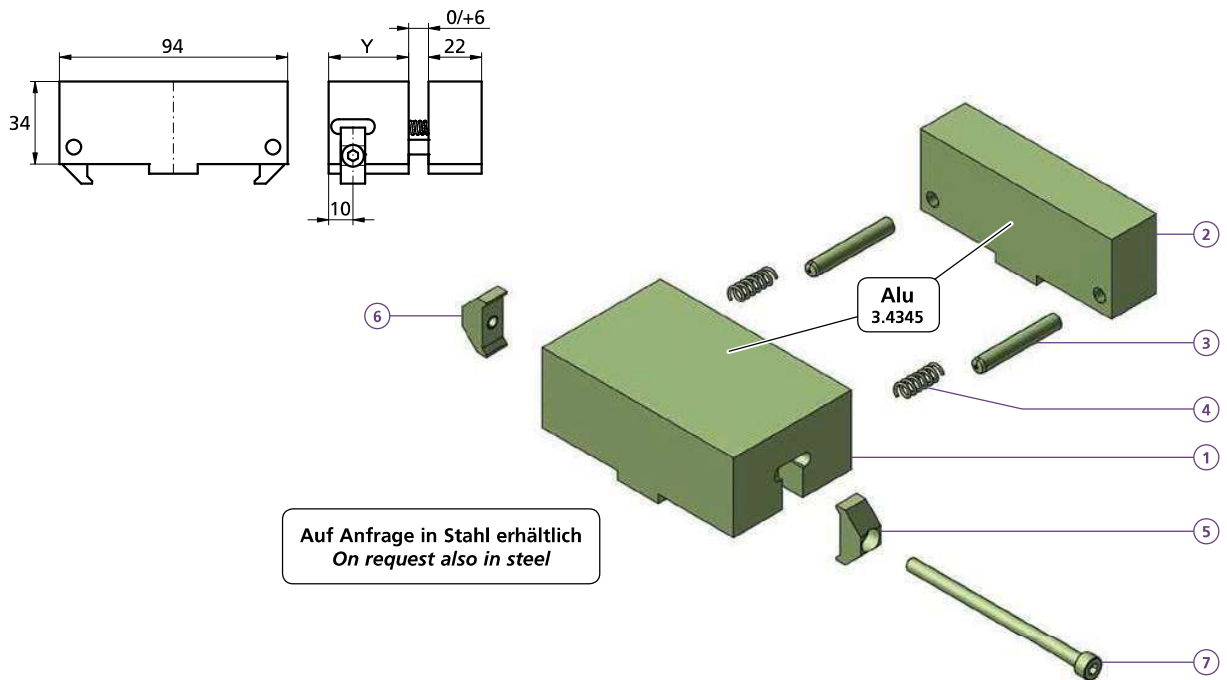

**PCFM3322**

- 1 1x PCFM33
- 2 1x PCFF22
- 3 2x CCBO0801
- 4 2x FED0618
- 5 1x PCSP10B
- 6 1x PCSP10G
- 7 1x M5X85ISO4762

Y = 33  
kg ~0,52

**PCFM5822**

- 1 1x PCFM58

Y = 58  
kg ~0,75

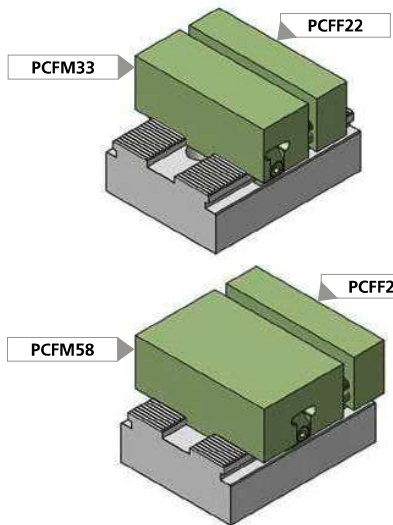

**PCSP10SET** kg ~0,04

- 1 1x PCSP10G
- 2 1x PCSP10B
- 3 1x M5X85ISO4762

Bestellbeispiel / Ordering example: **PCFM3322**

**Anschlagbacke flach**  
*Jaw flat stop*

	B	H	kg
PCUD34093TG	93	34	~0,11
PCUD49093TG	93	49	~0,14

**Unterlagen gehärtet und geschliffen**  
*Parallels hardened and ground*

Type		B	H	kg
I	PCUD14093	93	14	~0,05
I	PCUD20093	93	20	~0,06
I	PCUD24093	93	24	~0,08
I	PCUD29093	93	29	~0,09
II	PCUD31093	93	31	~0,10
I	PCUD34093	93	34	~0,11
I	PCUD39093	93	39	~0,12
I	PCUD44093	93	44	~0,14
II	PCUD46093	93	46	~0,14
I	PCUD47093	93	37	~0,15

# Niederzugbacken und magnetische Parallelunterlagen

## Pull-down jaws and magnetic steel parallels



powerCLAMP

### Niederzugbacken für die Anschlagseite

#### Pull-down jaws for the solid reference face

Art. Nr.	kg	H	Z
<b>PC9434NVB</b>	~0,24	49,8 – 49	10,21 – 10
<b>PC9449NVB</b>	~0,35	34,8 – 34	10,21 – 10

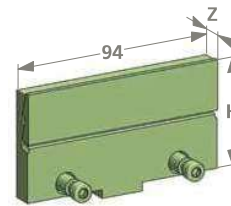

Die Niederzugbacke dient um einen zusätzlichen Niederzugsklemmdruck auf der Anschlagseite zu erhalten.

The pull-down jaw is used to obtain an additional pull-down clamping pressure on the end module side.

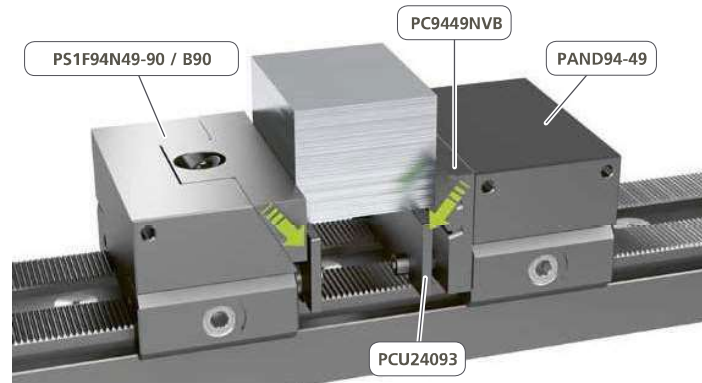

### Magnetische Parallelunterlagen

#### Magnetic steel parallels

Art. Nr.	kg	H
<b>PCUM1409308</b>	~0,09	14
<b>PCUM2009308</b>	~0,13	20
<b>PCUM2409308</b>	~0,15	24
<b>PCUM2909308</b>	~0,18	29
<b>PCUM3109308</b>	~0,20	31
<b>PCUM3409308</b>	~0,21	34
<b>PCUM3909308</b>	~0,24	39
<b>PCUM4409308</b>	~0,27	44
<b>PCUM4609308</b>	~0,28	46

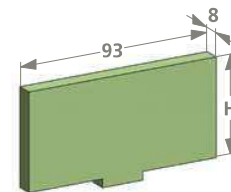

Mit diesen magnetischen Parallelunterlagen ist die Positionierung auf der Basisschiene frei wählbar. Bei Werkstücken mit grösseren Rundungen sind die Spannbacken B122P / B123P inklusive das Anschlagmodul PAND94-34PRGV / PAND94-49PRGV bestens geeignet.

With these magnetic steel parallels, the positioning on the base rail is freely selectable. For workpieces with larger curves, the clamping jaws B122P / B123P including the end module PAND94-34PRGV / PAND94-49PRGV are best suited.

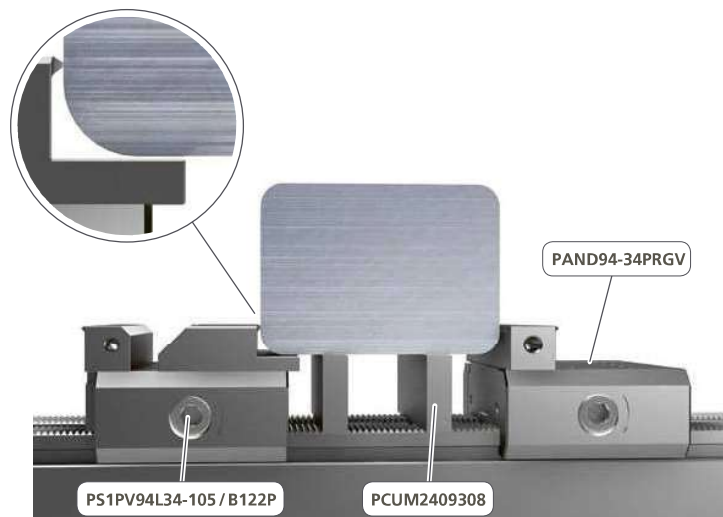

SCAN OR  
CLICK



PDF



STEP

